

*APPENDIX A: CALCULATING THE
DESIGN POPULATION*

The current population of Converse County is reported at 12,515. Roughly 5,500 people live in Douglas, the county seat and largest community in the county. Another 2,200 live in Glenrock, the second largest community in the county. The remaining population – roughly 4,800 – live in smaller communities and rural parts of the county.

Population forecasts are difficult to come by, in part due to the cyclical nature of the local economy, which is closely tied to mineral production. The population has generally increased over the last 10+ years, and some local forecasters have called for an increase of 10% in the next ten years. This would grow the population to 13,766 by roughly 2015. If that rate of growth were to continue to the year 2030, the county population would grow to 15,143.

Figure A(1) illustrates two growth models that result in a county population of 15,143 in the year 2030. The first calculates the annual rate of growth through the year 2015 based on a rolling average of the three preceding years. After 2015, the annual growth rate gradually declines. The second model extends the recent annual rate of growth for the next two to three years, but then reduces the annual rate of growth over the following ten years. The growth rate again picks up, then declines again. The second scenario more closely reflects the county-wide pattern of growth spurts.

Both models lead to a projected population of 15,143.

**FIGURE A(1)
 CONVERSE COUNTY POPULATION GROWTH**

	Projection 1		Projection 2	
	Population	Pct change	Population	Pct change
2005	12,515	1.50%	12,515	1.50%
2006	12,627	0.89%	12,703	1.50%
2007	12,752	0.99%	12,862	1.25%
2008	12,896	1.13%	12,990	1.00%
2009	13,026	1.01%	13,088	0.75%
2010	13,162	1.04%	13,166	0.60%
2011	13,301	1.06%	13,232	0.50%
2012	13,439	1.04%	13,285	0.40%
2013	13,579	1.05%	13,325	0.30%
2014	13,721	1.05%	13,358	0.25%
2015	13,859	1.00%	13,391	0.25%
2016	13,990	0.95%	13,425	0.25%
2017	14,116	0.90%	13,458	0.25%
2018	14,236	0.85%	13,526	0.50%
2019	14,350	0.80%	13,627	0.75%
2020	14,458	0.75%	13,763	1.00%
2021	14,559	0.70%	13,935	1.25%
2022	14,653	0.65%	14,110	1.25%
2023	14,741	0.60%	14,286	1.25%
2024	14,822	0.55%	14,465	1.25%
2025	14,897	0.50%	14,631	1.15%
2026	14,964	0.45%	14,785	1.05%
2027	15,023	0.40%	14,918	0.90%
2028	15,076	0.35%	15,030	0.75%
2029	15,121	0.30%	15,105	0.50%
2030	15,144	0.15%	15,142	0.25%

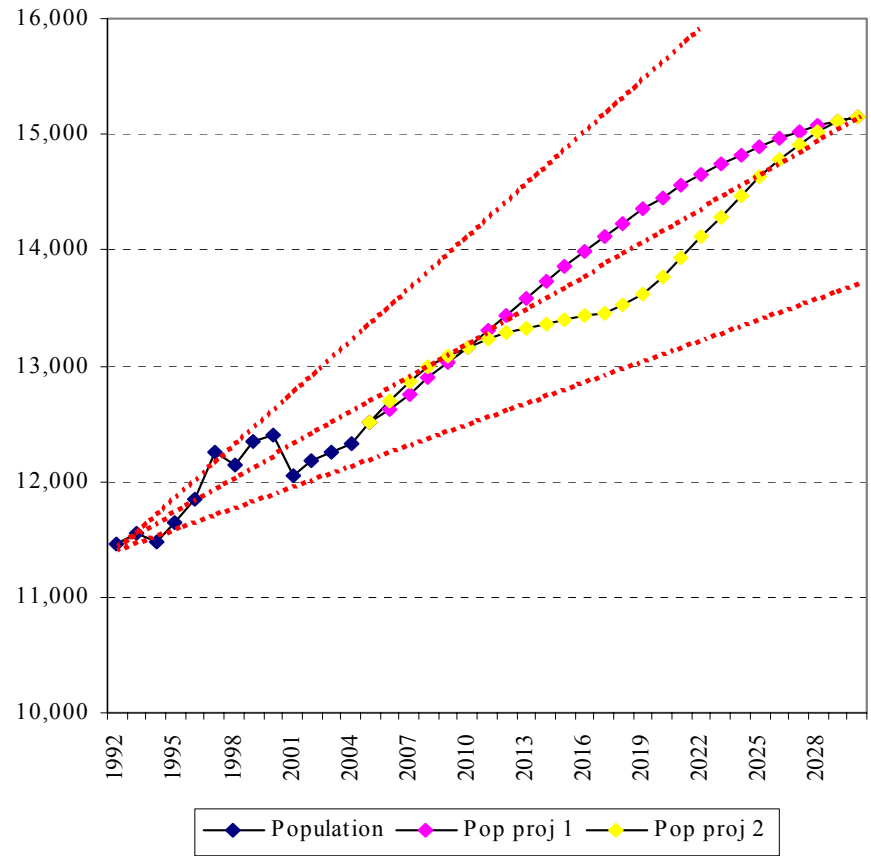

*APPENDIX B: ANNUAL REPORT
SUMMARY*

The following pages present a summary of the statistics submitted by the Converse County Library District in its annual reports to the Wyoming state library agency from 1992 through 2005. This data is useful for tracking local trends over time. It is important to note that some inconsistencies exist in the data, as recommended tallying methods changed from time to time. Also, the state library agency changed its reporting protocols over time, so some data elements have not been gathered during the entire reporting period. Occasionally, individual data elements were not reported by the library, and in such cases, data for the Converse County Library has been interpolated, usually by calculating the average of the reported data from the preceding and following years. When a data element has been interpolated in this manner, it is highlighted.

**CONVERSE COUNTY PUBLIC LIBRARY
ANNUAL REPORT DATA SUMMARY**

	1992	1993	1994	1995	1996	1997	1998	1999	2000	2001	2002	2003	2004	2005	For the period	High	Low	Average
Population	11,457	11,560	11,470	11,650	11,850	12,260	12,150	12,337	12,396	12,052	12,186	12,258	12,330	12,515		12,515	11,457	12,034
REGISTRATION																		
NOTE: prior to FY03 state library annual report form did NOT request separate data for each service outlet																		
Registered borrowers				6,026	6,164	7,257	8,154	7,911	7,667	7,550	7,047	6,544	7,574	6,660		8,154	6,026	7,141
<i>Increase over prev yr</i>				138	1,093	897	-244	-244	-117	-503	-503	1,030	-914		1,093	-914	63	
<i>Reg as pct of pop</i>			51.73%	52.02%	59.19%	67.11%	64.12%	61.85%	62.65%	57.83%	53.39%	61.43%	53.22%		67.11%	51.73%	58.59%	
Douglas							6,238	5,867	5,495	5,343	5,071	4,799			6,238	4,799	5,469	
Glenrock							1,916	2,044	2,172	2,207	1,976	1,745			2,207	1,745	2,010	
<i>Douglas pct of total</i>							76.50%	74.16%	71.67%	70.77%	71.96%	73.33%			76.50%	70.77%	73.07%	
HOURS																		
NOTE: prior to FY03 state library annual report form did NOT request separate data for each service outlet																		
Hours of service per wk	3,600	3,779	3,700	3,848	3,848	3,848	3,848	3,706	3,994	4,137	4,529	4,628	4,628	4,628		4,628	3,600	4,052
Douglas							1,924	1,853	2,126	2,137	2,543	2,600	2,600					
Glenrock							1,924	1,853	1,868	2,000	1,986	2,028	2,028					
STAFFING																		
MLS librarian	0.00	0.00	0.00	0.00	0.00	0.00	0.00	0.00	0.00	0.00	0.00	0.00	0.00	0.00		0.00	0.00	0.00
Other librarian	1.00	8.80	9.55	9.45	6.13	6.05	6.13	6.08	6.00	6.00	6.15	6.60	7.38	7.38		9.55	1.00	6.62
Other paid staff	7.80	0.00	0.00	0.00	2.55	3.48	2.80	2.88	2.93	3.18	3.43	3.33	4.08	2.93				
TOTAL	8.80	8.80	9.55	9.45	8.68	9.53	8.93	8.96	8.93	9.18	9.58	9.93	11.45	10.28		11.45	8.68	9.43
<i>Increase over prev yr</i>		0.00	0.75	-0.10	-0.77	0.85	-0.60	0.03	-0.03	0.25	0.40	0.35	1.52	-1.17		1.52	-1.17	0.11
<i>FTE per 1,000 pop</i>	0.77	0.76	0.83	0.81	0.73	0.78	0.73	0.73	0.72	0.76	0.79	0.81	0.93	0.82		0.93	0.72	0.78
<i>MLS as pct of total</i>	0.00%	0.00%	0.00%	0.00%	0.00%	0.00%	0.00%	0.00%	0.00%	0.00%	0.00%	0.00%	0.00%	0.00%		0.00%	0.00%	0.00%

**CONVERSE COUNTY PUBLIC LIBRARY
 ANNUAL REPORT DATA SUMMARY**

	1992	1993	1994	1995	1996	1997	1998	1999	2000	2001	2002	2003	2004	2005	For the period	High	Low	Average
COLLECTIONS																		
NOTE: prior to FY03 state library annual report form did NOT request separate data for each service outlet																		
Books																		
Volumes held	68,505	67,072	63,313	64,221	63,310	61,680	58,154	57,993	54,708	49,001	50,232	49,884	51,291	49,048		68,505	49,001	57,744
Douglas							42,777	42,185	39,142	34,109	34,975	33,402	35,833	34,607		42,777	33,402	37,129
Glenrock							15,377	15,808	15,566	14,892	15,257	16,482	15,458	14,441		16,482	14,441	15,410
<i>Douglas pct of total</i>							73.56%	72.74%	71.55%	69.61%	69.63%	66.96%	69.86%	70.56%		73.56%	66.96%	70.56%
Videos																		
Videos held	971	1,213	1,422	1,655	1,518	2,014	2,172	2,332	2,396	2,524	2,704	2,364	2,597	2,838		2,838	971	2,051
Douglas							1,458	1,589	1,607	1,705	1,970	1,710	1,844	1,971		1,971	1,458	1,732
Glenrock							714	743	789	819	734	654	753	867		867	654	759
<i>Douglas pct of total</i>							67.13%	68.14%	67.07%	67.55%	72.86%	72.34%	71.01%	69.44%		72.86%	67.07%	69.44%
Audio recordings																		
Held	1,495	1,590	1,575	1,700	850	1,107	1,243	1,507	1,740	2,097	2,312	2,403	2,736	3,150		3,150	850	1,822
Douglas							826	1,018	1,123	1,365	1,519	1,591	1,806	2,077		2,077	826	1,416
Glenrock							417	489	617	732	793	812	753	1,073		1,073	417	711
<i>Douglas pct of total</i>							66.45%	67.55%	64.54%	65.09%	65.70%	66.21%	66.01%	65.94%		67.55%	64.54%	65.94%
Periodicals																		
Titles held	127	135	140	126	140	101	119	112	131	134	128	104	107	165		165	101	126
Douglas							62	65	73	74	69	64	67		74	62	68	
Glenrock							57	47	58	60	59	50	40		60	40	53	
<i>Volumes held per cap</i>	5.98	5.80	5.52	5.51	5.34	5.03	4.79	4.70	4.41	4.07	4.12	4.07	4.16	3.92		5.98	3.92	4.82
<i>Videos per 1,000 pop</i>	84.75	104.93	123.98	142.06	128.10	164.27	178.77	189.02	193.29	209.43	221.89	192.85	210.62	226.77		226.77	84.75	169.34
<i>Audios per 1,000 pop</i>	130.49	137.54	137.31	145.92	71.73	90.29	102.30	122.15	140.37	174.00	189.73	196.04	221.90	251.70		251.70	71.73	150.82
<i>Nonprint as pct of print</i>	3.60%	4.18%	4.73%	5.22%	3.74%	5.06%	5.87%	6.62%	7.56%	9.43%	9.99%	9.56%	10.40%	12.21%		12.21%	3.60%	7.01%
<i>Video pct of nonprint</i>	39.38%	43.28%	47.45%	49.33%	64.10%	64.53%	63.60%	60.74%	57.93%	54.62%	53.91%	49.59%	48.70%	47.39%				
<i>Periodicals per 1,000 pop</i>	11.08	11.68	12.21	10.82	11.81	8.24	9.79	9.08	10.57	11.12	10.50	8.48	8.68	13.18		13.18	8.24	10.52

**CONVERSE COUNTY PUBLIC LIBRARY
ANNUAL REPORT DATA SUMMARY**

	1992	1993	1994	1995	1996	1997	1998	1999	2000	2001	2002	2003	2004	2005	For the period	High	Low	Average
CIRCULATION MEASURES																		
NOTE: prior to FY03 state library annual report form did NOT request separate data for each service outlet																		
Douglas adult							45,363	46,432	47,335	44,260	47,896	47,498	44,428	58,277	381,489	58,277	44,260	47,686
Douglas juvenile							16,516	14,914	15,994	17,394	19,108	23,604	22,099	23,947	153,576	23,947	14,914	19,197
Glenrock adult							18,319	20,651	19,559	17,904	19,076	17,698	17,004	23,202	153,413	23,202	17,004	19,177
Glenrock juvenile							10,580	12,703	8,664	8,443	8,270	7,845	8,241	12,215	76,961	12,703	7,845	9,620
TOTAL CIRC	97,198	89,802	88,115	76,645	79,088	84,392	90,778	94,700	91,552	88,001	94,350	96,645	91,772	117,641	1,280,679	117,641	76,645	91,477
<i>Increase over prev yr</i>		-7,396	-1,687	-11,470	2,443	5,304	6,386	3,922	-3,148	-3,551	6,349	2,295	-4,873	25,869		25,869	-11,470	1,573
<i>% increase over prev yr</i>		-7.61%	-1.88%	-13.02%	3.19%	6.71%	7.57%	4.32%	-3.32%	-3.88%	7.21%	2.43%	-5.04%	28.19%		28.19%	-13.02%	1.91%
<i>Circulation per capita</i>	8.48	7.77	7.68	6.58	6.67	6.88	7.47	7.68	7.39	7.30	7.74	7.88	7.44	9.40		9.40	6.58	7.60
<i>Turnover rate</i>	1.42	1.34	1.39	1.19	1.25	1.37	1.56	1.63	1.67	1.80	1.88	1.94	1.79	2.40		2.40	1.19	1.62
Douglas total							61,879	61,346	63,329	61,654	67,004	71,102	66,527	82,224	535,065	82,224	61,346	66,883
Glenrock total							28,899	33,354	28,223	26,347	27,346	25,543	25,245	35,417	230,374	35,417	25,245	28,797
<i>Douglas pct of total</i>							68.17%	64.78%	69.17%	70.06%	71.02%	73.57%	72.49%	69.89%	41.78%	73.57%	64.78%	69.89%
Adult total	78,939	49,786	52,503	59,475	54,657	57,629	65,032	67,083	66,894	62,164	66,972	65,196	61,432	81,479	889,241	81,479	49,786	63,517
Juvenile total	18,259	40,016	35,612	17,170	24,431	26,763	25,746	27,617	24,658	25,837	27,378	31,449	30,340	36,162	391,438	40,016	17,170	27,960
<i>Adult pct of total</i>							71.64%	70.84%	73.07%	70.64%	70.98%	67.46%	66.94%	69.26%	69.44%	73.07%	66.94%	70.10%
<i>Adult pct of Douglas total</i>							73.31%	75.69%	74.74%	71.79%	71.48%	66.80%	66.78%	70.88%	71.30%	75.69%	66.78%	71.43%
<i>Adult pct of Glenrock total</i>							63.39%	61.91%	69.30%	67.95%	69.76%	69.29%	67.36%	65.51%	66.59%	69.76%	61.91%	66.81%
Interlibrary loan to others	85	186	343	284	219	559	581	597	610	537	600	1,004	790	913	7,308	1,004	85	522
Interlibrary loan from others	352	351	293	217	383	199	399	405	419	359	361	302	401	423	4,864	423	199	347
<i>Ratio from : to</i>	4.14	1.89	0.85	0.76	1.75	0.36	0.69	0.68	0.69	0.67	0.60	0.30	0.51	0.46	0.67	4.14	0.30	1.02

**CONVERSE COUNTY PUBLIC LIBRARY
 ANNUAL REPORT DATA SUMMARY**

	1992	1993	1994	1995	1996	1997	1998	1999	2000	2001	2002	2003	2004	2005	For the period	High	Low	Average
OTHER SERVICE MEASURES																		
NOTE: prior to FY03 state library annual report form did NOT request separate data for each service outlet																		
Attendance	58,200	51,400	50,197	55,855	48,393	50,793	51,918	52,510	53,998	50,420	54,002	76,317	78,616	88,439	821,058	88,439	48,393	58,647
<i>Attendance per capita</i>	5.08	4.45	4.38	4.79	4.08	4.14	4.27	4.26	4.36	4.18	4.43	6.23	6.38	7.07		7.07	4.08	4.86
Douglas							35,595	34,358	39,954	35,215	38,827	50,462	51,237		285,648	51,237	34,358	40,807
Glenrock							16,323	18,152	14,044	15,205	15,175	25,855	27,379		132,133	27,379	14,044	18,876
<i>Douglas pct of total</i>							68.56%	65.43%	73.99%	69.84%	71.90%	66.12%	65.17%		34.79%			
Reference		2,500	2,500	3,900	4,440	4,940	8,580	18,935	9,382	10,318	10,265	11,055	15,993	34,674	137,482	34,674	2,500	10,576
<i>Reftransac per capita</i>		0.22	0.22	0.33	0.37	0.40	0.71	1.53	0.76	0.86	0.84	0.90	1.30	2.77		2.77	0.22	0.86
Douglas							7,800	17,710	8,316	9,465	9,496	10,308	15,225		78,320	17,710	7,800	11,189
Glenrock							780	1,225	1,066	853	769	747	768		6,208	1,225	747	887
<i>Douglas pct of total</i>							90.91%	93.53%	88.64%	91.73%	92.51%	93.24%	95.20%		56.97%			

**CONVERSE COUNTY PUBLIC LIBRARY
ANNUAL REPORT DATA SUMMARY**

	1992	1993	1994	1995	1996	1997	1998	1999	2000	2001	2002	2003	2004	2005	For the period	High	Low	Average
RECEIPTS (in \$000s)																		
Local	\$256	\$232	\$283	\$318	\$299	\$320	\$314	\$365	\$345	\$319	\$383	\$418	\$375	\$419	\$4,647	\$419	\$232	\$332
State	\$0	\$3	\$3	\$3	\$5	\$0	\$0	\$0	\$0	\$0	\$0	\$0	\$0	\$0	\$14	\$5	\$0	\$1
Federal	\$0	\$0	\$16	\$43	\$10	\$6	\$2	\$1	\$3	\$4	\$2	\$5	\$1	\$2	\$94	\$43	\$0	\$7
Other	\$15	\$16	\$14	\$16	\$18	\$16	\$16	\$15	\$18	\$16	\$31	\$12	\$10	\$13	\$226	\$31	\$10	\$16
TOTAL	\$272	\$250	\$316	\$381	\$332	\$342	\$332	\$381	\$366	\$339	\$416	\$435	\$387	\$434	\$4,982	\$435	\$250	\$356
<i>Increase over prev yr</i>		(\$21)	\$65	\$65	(\$49)	\$10	(\$10)	\$49	(\$15)	(\$27)	\$76	\$20	(\$49)	\$48		\$76	(\$49)	\$12
<i>Local pct of total</i>	94.31%	92.63%	89.68%	83.61%	90.02%	93.73%	94.62%	95.89%	94.41%	94.12%	92.08%	95.99%	97.02%	96.54%	93.29%	97.02%	83.61%	93.19%
<i>State pct of total</i>	0.00%	1.12%	0.90%	0.88%	1.45%	0.00%	0.00%	0.00%	0.00%	0.00%	0.00%	0.00%	0.00%	0.00%	0.28%	1.45%	0.00%	0.31%
<i>Federal pct of total</i>	0.00%	0.00%	5.11%	11.20%	3.16%	1.62%	0.54%	0.15%	0.80%	1.27%	0.41%	1.26%	0.29%	0.38%	1.89%	11.20%	0.00%	1.87%
<i>Other pct of total</i>	5.69%	6.25%	4.31%	4.31%	5.38%	4.65%	4.85%	3.97%	4.79%	4.61%	7.50%	2.75%	2.68%	3.08%	4.54%	7.50%	2.68%	4.63%
EXPENDITURES (in \$000s)																		
NOTE: prior to FY03 state library annual report form did NOT request separate data for print/nonprint collection expenditures																		
Salaries & wages	\$142	\$146	\$133	\$139	\$155	\$150	\$144	\$152	\$153	\$175	\$196	\$195	\$207	\$232				
Benefits	\$25	\$24	\$23	\$22	\$24	\$40	\$33	\$39	\$48	\$50	\$52	\$52	\$58	\$53				
Personnel	\$167	\$171	\$156	\$162	\$179	\$190	\$177	\$192	\$201	\$225	\$248	\$247	\$265	\$285	\$2,864	\$285	\$0	\$179
Print materials												\$39	\$39	\$41	\$119	\$41	\$39	\$40
Nonprint materials												\$20	\$22	\$25	\$68	\$25	\$20	\$23
Collections	\$32	\$31	\$46	\$45	\$44	\$43	\$42	\$42	\$49	\$47	\$49	\$59	\$62	\$66				
All other	\$46	\$42	\$44	\$41	\$61	\$60	\$82	\$75	\$66	\$80	\$65	\$82	\$105	\$103	\$952	\$105	\$41	\$68
OPERATING TOTAL	\$244	\$243	\$245	\$247	\$283	\$293	\$302	\$309	\$316	\$352	\$362	\$388	\$432	\$454	\$4,471	\$454	\$243	\$319
Capital expenditures	\$2	\$4	\$10	\$56	\$85	\$29	\$4	\$13	\$53	\$0	\$18	\$29	\$0	\$0				
TOTAL	\$246	\$247	\$255	\$304	\$369	\$322	\$306	\$322	\$369	\$352	\$380	\$417	\$432	\$454	\$4,774	\$454	\$246	\$341
<i>Increase over prev yr</i>		\$1	\$8	\$49	\$65	(\$47)	(\$16)	\$16	\$47	(\$17)	\$28	\$37	\$15	\$22		\$65	(\$47)	\$16
<i>Revenue over (under) exp</i>	\$26	\$3	\$61	\$77	(\$37)	\$20	\$26	\$59	(\$3)	(\$13)	\$36	\$19	(\$45)	(\$20)		\$77	(\$45)	\$15
<i>Op incr over prev yr</i>		(\$1)	\$1	\$3	\$36	\$10	\$9	\$7	\$7	\$36	\$10	\$26	\$44	\$22		\$44	(\$1)	\$16
<i>Salaries pct of op total</i>	68.34%	70.06%	63.56%	65.37%	63.25%	64.88%	58.77%	62.07%	63.69%	63.83%	68.56%	63.66%	61.43%	62.75%	64.07%	70.06%	58.77%	64.30%
<i>Material pct of op total</i>	12.93%	12.69%	18.61%	18.00%	15.37%	14.60%	14.00%	13.69%	15.39%	13.45%	13.44%	15.19%	14.31%	14.53%	14.64%	18.61%	12.69%	14.73%
<i>Expenditure per capita</i>	\$21.46	\$21.40	\$22.22	\$26.06	\$31.12	\$26.26	\$25.19	\$26.09	\$29.79	\$29.23	\$31.19	\$33.99	\$35.02	\$36.27		\$36.27	\$21.40	\$28.24
<i>Op expend per capita</i>	\$21.30	\$21.06	\$21.34	\$21.23	\$23.91	\$23.89	\$24.83	\$25.03	\$25.50	\$29.23	\$29.71	\$31.67	\$35.02	\$36.27		\$36.27	\$21.06	\$26.43
<i>Matl expend per capita</i>	\$2.75	\$2.67	\$3.97	\$3.82	\$3.67	\$3.49	\$3.48	\$3.43	\$3.92	\$3.93	\$3.99	\$4.81	\$5.01	\$5.27		\$5.27	\$2.67	\$3.87

APPENDIX C: NCES DATA SUMMARY

A useful source of information on public libraries across the country is the database developed each year by the National Center for Educational Statistics (NCES) in the U.S. Department of Education, drawn from annual report summaries submitted by the state library agencies. This resource was used to draw several sample groups of libraries to compare with the Converse County Library in an effort to assess “norms” for libraries serving populations of similar size. The samples included:

- All Wyoming libraries
- Wyoming libraries / 10,000 to 25,000 pop (more or less bracketing the library’s current and projected population)
- U.S. libraries / 12,000 to 13,000 pop (more or less bracketing the library’s current population)
- U.S. libraries / 14,000 to 16,000 pop (more or less bracketing the library’s projected population)
- U.S. county libraries / 11,000 to 14,000 pop (more or less bracketing the library’s current population)
- U.S. county libraries / 13,000 to 17,000 pop (more or less bracketing the library’s projected population)
- All High Plains regional
- High Plains regional libraries / 10,000 to 25,000 pop (more or less bracketing the library’s current and projected population)

Data for Converse County is reported down the left side of each page.

The data analysis includes the high and low of the data range, quartile distributions, the average for the sample, and the library's z-score against the sample. The z-score is a simple statistical measure that assesses the library's deviation from the sample mean. A positive z-score indicates that the library's result is above the sample average; a negative z-score indicates a result below the average. In a rough analogy to a bell curve, a z-score of ± 1.00 or more means that the library's result is moving into the tail of the curve, in the top or bottom 16% of the sample. A z-score of ± 2.00 or more indicates that the library's result is even farther into the tail, in the top or bottom 2% to 3% of the sample. A higher z-score means a greater the departure between the library's result and the sample average. Additional analyses were conducted to calculate for each of these sample populations the percentile results at the 30th, 40th, 60th, 70th, 80th, 85th, 90th, and 95th percentiles.

ALL WYOMING LIBRARIES

	Converse Cty Libr	%ile rank	n=	Low	25th %ile	30th %ile	40th %ile	50th %ile	60th %ile	70th %ile	75th %ile	80th %ile	85th %ile	90th %ile	95th %ile	High	Average	z=	
Population	12,433	45.40	23	2,302	7,709	8,453	12,038	14,890	18,827	26,300	29,325	34,363	36,112	36,978	64,322	82,894	21,683	-0.46	
Configuration																			
Central	1	0.00	23	1	1	1	1	1	1	1	1	1	1	1	1	1	1	1	#####
Branch	1	13.60	23	0	1	1	2	2	2	2	3	3	3	5	7	8	2	-0.60	
Bookmobile	0	0.00	23	0	0	0	0	0	0	0	0	0	0	1	1	1	0	-0.38	
Hours open	4,628	27.20	23	1,676	4,481	4,815	5,008	5,427	5,636	6,744	7,029	7,225	7,776	8,206	9,180	12,357	5,726	-0.46	
Holdings																			
Volumes held	49,884	13.60	23	34,311	56,838	60,033	72,581	91,635	111,985	125,724	142,797	154,707	194,789	210,183	212,925	243,533	107,267	-0.91	
Periodical subscriptions	139	31.80	23	48	126	136	149	213	232	266	280	291	320	427	539	627	228	-0.60	
Audio recordings held	2,403	45.40	23	513	1,321	1,618	2,251	2,463	3,244	3,679	5,087	6,401	8,677	12,947	13,930	14,894	4,308	-0.43	
Video recordings held	2,364	45.40	23	445	1,349	1,500	1,964	2,689	3,267	4,558	4,944	5,507	6,055	6,444	11,168	14,753	3,700	-0.37	
Holdings analysis																			
<i>Volumes held per capita</i>	4.01	18.10	23	2.80	4.47	4.58	5.43	5.90	6.80	7.43	7.51	9.11	10.35	10.77	12.39	15.14	6.70	-0.83	
<i>Subscrips per 1,000 pop</i>	11.18	59.00	23	5.08	7.76	7.92	9.90	10.61	12.03	16.27	17.75	19.29	21.67	38.09	45.64	48.22	15.76	-0.36	
<i>Audios per 1,000 pop</i>	193.28	50.00	23	47.10	122.84	149.20	166.90	193.28	212.51	225.22	229.67	295.07	360.92	404.11	505.29	643.91	220.50	-0.18	
<i>Videos per 1,000 pop</i>	190.14	54.50	23	14.02	120.39	129.71	154.73	179.03	206.08	220.63	226.00	279.77	337.92	350.27	387.73	799.52	211.11	-0.13	
<i>Nonprint as pct of print</i>	9.56%	81.80	23	1.66%	4.05%	4.21%	4.85%	5.78%	6.17%	7.75%	8.84%	9.45%	11.12%	12.08%	13.67%	19.25%	6.87%	0.64	
Automation access																			
Internet PCs for public	18	63.60	23	5	9	9	14	16	16	19	24	27	27	31	52	64	19	-0.05	
<i>Public PCs per 1,000 pop</i>	1.45	77.20	23	0.40	0.68	0.76	0.81	0.98	1.04	1.19	1.40	1.45	1.64	2.08	2.52	3.54	1.15	0.40	
<i>Public PCs per 1,000 visits</i>	0.24	86.30	23	0.08	0.10	0.11	0.14	0.16	0.16	0.20	0.21	0.23	0.23	0.34	0.36	0.47	0.18	0.56	
<i>Public PCs per 1,000 vol</i>	0.36	95.40	23	0.08	0.12	0.12	0.15	0.15	0.17	0.19	0.22	0.25	0.26	0.28	0.35	0.38	0.18	2.17	
Internet PCs for staff																			
<i>Staff PCs per FTE</i>																			

ALL WYOMING LIBRARIES

	Converse Cty Libr	%ile rank	n=	Low	25th %ile	30th %ile	40th %ile	50th %ile	60th %ile	70th %ile	75th %ile	80th %ile	85th %ile	90th %ile	95th %ile	High	Average	z=
Circulation																		
Circulation	96,645	50.00	23	21,814	63,177	74,403	80,823	96,645	163,461	181,133	271,215	360,060	364,790	368,456	398,982	625,326	176,818	-0.50
J circulation	31,449	50.00	23	6,051	16,262	18,840	22,278	31,449	56,519	75,848	90,557	105,235	112,279	136,422	148,250	201,812	58,466	-0.50
<i>J circ as pct of total</i>	32.54%	68.10	23	15.65%	28.41%	28.62%	29.98%	31.25%	31.74%	32.90%	34.37%	35.78%	36.75%	39.35%	40.01%	47.99%	31.25%	0.19
<i>Circulation per capita</i>	7.77	50.00	23	4.53	6.43	7.16	7.26	7.77	8.35	9.61	10.29	10.80	10.94	12.12	13.59	19.58	8.58	-0.23
<i>Circulation per visit</i>	1.27	50.00	23	0.76	0.99	1.05	1.16	1.27	1.54	1.62	1.70	1.74	1.86	1.92	1.98	2.44	1.37	-0.23
<i>Circ per item held</i>	1.94	86.30	23	0.63	0.94	1.08	1.19	1.35	1.52	1.69	1.83	1.92	1.93	2.40	2.56	4.35	1.50	0.52
<i>Circ per FTE staff</i>	9,733	40.90	23	6,730	8,885	9,394	9,723	9,886	9,990	10,786	11,102	11,247	12,201	14,104	15,049	19,167	10,407	-0.24
<i>Expenditure per circ</i>	\$4.02	54.50	23	\$2.36	\$3.44	\$3.56	\$3.74	\$3.90	\$4.10	\$4.47	\$4.91	\$5.30	\$5.45	\$5.85	\$6.50	\$6.68	\$4.21	-0.16
Interlibrary loans																		
Loans to	1,004	50.00	23	218	415	437	630	1,004	1,047	1,147	1,418	1,719	1,781	2,019	2,269	2,480	1,004	0.00
Loans from	302	18.10	23	125	326	393	531	680	1,273	1,548	1,625	1,701	1,985	2,259	2,500	3,582	1,089	-0.85
<i>Net lending</i>	702	100.00	23	-1,835	-191	-138	26	58	97	213	265	293	340	398	558	702	-84	1.31
Library visits																		
Library visits	76,317	40.90	23	13,813	50,544	56,763	74,187	85,997	104,698	169,451	188,715	204,736	225,992	241,914	298,275	400,000	125,652	-0.50
<i>Library visits per capita</i>	6.14	50.00	23	2.60	4.74	4.98	5.86	6.14	6.31	7.10	7.27	7.44	9.15	12.73	16.08	16.37	6.94	-0.21
Reference transactions																		
Reference transactions	11,055	45.40	23	1,010	4,582	6,017	9,407	12,880	18,575	29,006	35,065	36,294	37,993	47,311	62,048	89,626	21,659	-0.47
<i>Ref transac per capita</i>	0.89	54.50	23	0.12	0.50	0.62	0.73	0.81	1.05	1.27	1.44	1.80	1.95	2.24	2.44	2.48	1.05	-0.21
Staffing																		
MLS librarians	0.00	0.00	23	0.00	0.00	0.00	0.00	0.00	1.00	2.40	3.00	3.30	4.45	4.97	5.63	6.00	1.57	-0.74
Other librarians	6.60	72.70	23	0.00	2.30	2.58	3.00	3.90	4.80	6.39	6.68	7.04	7.42	7.86	10.13	16.33	4.65	0.51
Other paid staff	3.33	40.90	23	0.00	0.50	1.40	3.31	9.03	10.32	14.84	17.18	20.76	22.61	27.35	29.47	32.50	10.57	-0.68
Total FTEs	9.93	40.90	23	2.20	6.50	7.06	9.53	11.50	16.99	20.50	24.10	27.60	34.31	37.92	41.07	43.66	16.79	-0.52
<i>Staff FTE / 1,000 pop</i>	0.80	50.00	23	0.30	0.64	0.67	0.71	0.80	0.91	0.98	1.05	1.09	1.13	1.17	1.78	2.06	0.88	-0.19
<i>MLS pct of total staff</i>	0.00%	0.00	23	0.00%	0.00%	0.00%	0.00%	0.00%	4.57%	9.66%	11.44%	12.97%	15.98%	17.18%	20.47%	31.53%	6.27%	-0.72

ALL WYOMING LIBRARIES

	Converse Cty Libr	%ile rank	n=	Low	25th %ile	30th %ile	40th %ile	50th %ile	60th %ile	70th %ile	75th %ile	80th %ile	85th %ile	90th %ile	95th %ile	High	Average	z=
Revenue / Income (000s)																		
Local government	\$418	40.90	23	\$64	\$214	\$230	\$384	\$501	\$620	\$775	\$838	\$1,147	\$1,604	\$2,178	\$2,330	\$2,528	\$759	-0.45
State government	\$0	0.00	23	\$0	\$0	\$0	\$0	\$0	\$0	\$0	\$0	\$0	\$0	\$1	\$4	\$9	\$1	-0.31
Federal government	\$5	86.30	23	\$0	\$1	\$1	\$1	\$2	\$2	\$3	\$3	\$4	\$5	\$6	\$6	\$12	\$3	1.09
Other income	\$12	36.30	23	\$3	\$9	\$11	\$13	\$24	\$36	\$40	\$52	\$68	\$73	\$74	\$78	\$227	\$39	-0.56
Total income	\$435	40.90	23	\$90	\$220	\$237	\$400	\$520	\$638	\$841	\$899	\$1,189	\$1,779	\$2,277	\$2,406	\$2,613	\$801	-0.46
Revenue Analysis																		
Local as pct of total	95.99%	54.50	23	70.81%	91.90%	94.20%	95.66%	95.97%	96.51%	96.73%	96.76%	96.79%	97.10%	97.46%	98.01%	98.44%	93.21%	0.43
State as pct of total	0.00%	0.00	23	0.00%	0.00%	0.00%	0.00%	0.00%	0.00%	0.00%	0.00%	0.00%	0.00%	0.07%	1.00%	3.05%	0.18%	-0.28
Federal as pct of total	1.26%	100.00	23	0.00%	0.20%	0.24%	0.38%	0.45%	0.59%	0.69%	0.76%	0.83%	0.98%	1.10%	1.20%	1.26%	0.52%	1.92
Other as pct of total	2.75%	27.20	23	1.27%	2.73%	2.79%	2.99%	3.43%	4.00%	4.89%	7.04%	9.56%	11.12%	13.49%	14.21%	28.36%	6.08%	-0.54
Revenue per capita	\$35.01	54.50	23	\$16.37	\$23.14	\$24.90	\$31.43	\$32.78	\$35.29	\$38.48	\$40.09	\$41.15	\$59.13	\$69.56	\$84.99	\$126.80	\$39.42	-0.17
Expenditures (000s)																		
Salaries	\$195	40.90	23	\$37	\$121	\$124	\$187	\$239	\$327	\$442	\$496	\$661	\$926	\$1,187	\$1,366	\$1,389	\$423	-0.53
Benefits	\$52	40.90	23	\$3	\$32	\$35	\$52	\$60	\$81	\$141	\$181	\$210	\$220	\$408	\$504	\$588	\$136	-0.50
Total staff expense	\$247	45.40	23	\$41	\$156	\$160	\$231	\$296	\$435	\$607	\$654	\$852	\$1,144	\$1,638	\$1,826	\$1,977	\$559	-0.53
Materials	\$59	45.40	23	\$6	\$35	\$36	\$46	\$60	\$68	\$85	\$101	\$129	\$174	\$240	\$264	\$298	\$88	-0.35
Other expense	\$82	50.00	23	\$11	\$40	\$43	\$55	\$82	\$92	\$147	\$170	\$197	\$226	\$268	\$427	\$637	\$134	-0.35
Total operating expense	\$388	40.90	23	\$94	\$224	\$236	\$374	\$445	\$607	\$811	\$885	\$1,179	\$1,916	\$2,163	\$2,307	\$2,686	\$782	-0.50
Capital expense	\$0	0.00	23	\$0	\$0	\$0	\$0	\$2	\$6	\$21	\$27	\$33	\$36	\$67	\$1,444	\$1,749	\$156	-0.32
Expenditure analysis																		
Benefits as pct of staff	21.24%	54.50	23	8.33%	16.78%	17.65%	19.06%	20.14%	22.80%	25.86%	27.60%	28.60%	29.54%	29.74%	30.03%	30.57%	21.36%	-0.02
Sal & ben as pct of op	63.66%	18.10	23	43.10%	66.69%	66.89%	68.63%	70.86%	71.62%	73.47%	73.98%	74.61%	75.65%	78.40%	80.31%	85.80%	68.90%	-0.56
Matl exp as pct of op	15.19%	63.60	23	4.90%	9.11%	9.77%	10.90%	13.55%	14.12%	15.59%	16.09%	17.27%	17.92%	18.45%	19.00%	24.05%	12.75%	0.48
Expenditure per capita	\$31.22	59.00	23	\$15.23	\$24.89	\$25.01	\$28.38	\$29.80	\$31.44	\$39.59	\$40.99	\$42.19	\$57.90	\$67.01	\$71.77	\$116.56	\$37.31	-0.26
Mats exp per capita	\$4.74	68.10	23	\$0.75	\$2.87	\$2.98	\$3.30	\$3.92	\$4.45	\$4.74	\$5.36	\$6.60	\$7.10	\$7.75	\$8.14	\$16.28	\$4.63	0.03

WYOMING LIBRARIES / 10,000 to 25,000 pop

	Converse Cty Libr	%ile rank	n=	Low	25th %ile	30th %ile	40th %ile	50th %ile	60th %ile	70th %ile	75th %ile	80th %ile	85th %ile	90th %ile	95th %ile	High	Average	z=	
Population	12,433	33.30	7	11,212	12,339	12,395	13,416	14,890	15,164	15,994	16,966	17,938	18,707	19,068	19,430	19,792	14,929	-0.76	
Configuration																			
Central	1	0.00	7	1	1	1	1	1	1	1	1	1	1	1	1	1	1	1	#####
Branch	1	16.60	7	0	1	1	1	2	3	3	4	5	5	6	6	7	3	-0.69	
Bookmobile	0	0.00	7	0	0	0	0	0	0	0	0	0	0	0	1	1	0	-0.38	
Hours open	4,628	16.60	7	2,444	4,797	4,898	5,190	5,527	6,579	7,476	7,770	8,064	8,362	8,669	8,975	9,282	6,055	-0.61	
Holdings																			
Volumes held	49,884	16.60	7	34,311	66,766	76,894	86,842	91,635	95,000	100,094	104,372	108,649	111,743	112,470	113,198	113,925	83,164	-1.10	
Periodical subscriptions	139	50.00	7	78	106	114	127	139	186	220	224	227	237	256	276	295	167	-0.35	
Audio recordings held	2,403	50.00	7	641	2,177	2,251	2,341	2,403	2,879	3,244	3,315	3,386	4,048	5,893	7,738	9,583	3,373	-0.34	
Video recordings held	2,364	33.30	7	476	1,677	2,089	2,654	3,090	3,188	3,267	3,286	3,305	3,638	4,599	5,559	6,520	2,859	-0.25	
Holdings analysis																			
<i>Volumes held per capita</i>	4.01	16.60	7	2.80	4.26	4.40	4.55	4.63	5.65	6.57	6.91	7.26	7.76	8.56	9.36	10.16	5.70	-0.68	
<i>Subscrips per 1,000 pop</i>	11.18	66.60	7	5.08	9.10	10.01	10.75	10.96	11.09	12.03	13.31	14.59	15.49	15.62	15.74	15.87	10.96	0.06	
<i>Audios per 1,000 pop</i>	193.28	66.60	7	52.35	155.70	159.20	170.20	183.20	189.24	200.73	211.92	223.10	259.06	344.58	430.09	515.60	212.34	-0.13	
<i>Videos per 1,000 pop</i>	190.14	50.00	7	38.88	122.21	142.56	169.73	190.14	205.78	216.68	217.37	218.07	231.76	271.44	311.12	350.80	179.86	0.10	
<i>Nonprint as pct of print</i>	9.56%	83.30	7	2.67%	4.52%	5.27%	5.87%	6.00%	6.52%	7.40%	8.21%	9.02%	10.53%	13.43%	16.34%	19.25%	7.62%	0.34	
Automation access																			
Internet PCs for public	18	83.30	7	5	11	12	14	15	16	16	17	18	19	24	28	32	15	0.30	
<i>Public PCs per 1,000 pop</i>	1.45	83.30	7	0.41	0.81	0.81	0.83	0.87	0.94	1.07	1.21	1.35	1.48	1.56	1.64	1.72	1.01	1.00	
<i>Public PCs per 1,000 visits</i>	0.24	83.30	7	0.09	0.12	0.13	0.16	0.20	0.21	0.22	0.23	0.23	0.25	0.29	0.33	0.36	0.19	0.46	
<i>Public PCs per 1,000 vol</i>	0.36	83.30	7	0.08	0.13	0.14	0.15	0.15	0.17	0.21	0.27	0.32	0.36	0.37	0.38	0.38	0.20	1.32	
Internet PCs for staff																			
<i>Staff PCs per FTE</i>																			

WYOMING LIBRARIES / 10,000 to 25,000 pop

	Converse Cty Libr	%ile rank	n=	Low	25th %ile	30th %ile	40th %ile	50th %ile	60th %ile	70th %ile	75th %ile	80th %ile	85th %ile	90th %ile	95th %ile	High	Average	z=
Circulation																		
Circulation	96,645	50.00	7	56,444	80,872	81,399	87,708	96,645	134,822	163,461	168,244	173,027	194,984	251,290	307,597	363,903	145,032	-0.46
J circulation	31,449	50.00	7	17,836	24,974	26,386	28,976	31,449	45,624	59,443	65,997	72,551	80,728	92,152	103,576	115,000	49,461	-0.51
<i>J circ as pct of total</i>	32.54%	66.60	7	28.28%	31.43%	31.53%	31.60%	31.60%	32.17%	32.72%	32.98%	33.25%	34.88%	39.25%	43.62%	47.99%	33.81%	-0.20
<i>Circulation per capita</i>	7.77	50.00	7	4.61	6.23	6.77	7.39	7.77	8.45	9.28	9.83	10.39	11.65	14.29	16.93	19.58	9.16	-0.27
<i>Circulation per visit</i>	1.27	33.30	7	0.99	1.23	1.25	1.37	1.53	1.77	1.93	1.95	1.97	2.03	2.17	2.30	2.44	1.62	-0.68
<i>Circ per item held</i>	1.94	83.30	7	0.70	1.14	1.32	1.52	1.65	1.81	1.93	1.93	1.93	2.18	2.90	3.63	4.35	1.83	0.09
<i>Circ per FTE staff</i>	9,733	33.30	7	7,654	9,623	9,689	9,737	9,743	9,860	10,155	10,479	10,802	11,045	11,127	11,208	11,289	9,841	-0.09
<i>Expenditure per circ</i>	\$4.02	66.60	7	\$3.01	\$3.54	\$3.60	\$3.71	\$3.82	\$3.94	\$4.30	\$4.73	\$5.16	\$5.49	\$5.65	\$5.80	\$5.95	\$4.19	-0.16
Interlibrary loans																		
Loans to	1,004	50.00	7	271	540	598	783	1,004	1,010	1,019	1,028	1,036	1,116	1,343	1,569	1,795	886	0.23
Loans from	302	33.30	7	135	271	289	357	440	952	1,340	1,410	1,480	1,583	1,755	1,926	2,098	862	-0.73
<i>Net lending</i>	702	100.00	7	-1,462	-111	-25	127	269	293	362	442	521	587	625	664	702	24	0.93
Library visits																		
Library visits	76,317	66.60	7	41,203	49,260	53,835	60,398	65,667	72,057	84,016	95,565	107,114	133,758	190,593	247,427	304,262	100,112	-0.25
<i>Library visits per capita</i>	6.14	83.30	7	2.68	4.06	4.27	4.50	4.65	5.34	5.87	5.97	6.07	7.16	10.23	13.30	16.37	6.25	-0.02
Reference transactions																		
Reference transactions	11,055	50.00	7	2,070	3,518	3,635	6,650	11,055	26,030	36,107	36,247	36,387	36,697	37,345	37,993	38,641	18,757	-0.44
<i>Ref transac per capita</i>	0.89	50.00	7	0.17	0.27	0.31	0.55	0.89	1.52	1.94	1.94	1.95	2.00	2.15	2.30	2.45	1.14	-0.26
Staffing																		
MLS librarians	0.00	0.00	7	0.00	0.00	0.00	0.00	0.00	0.00	0.40	1.00	1.60	2.10	2.40	2.70	3.00	0.71	-0.57
Other librarians	6.60	66.60	7	0.00	3.38	3.60	4.05	4.50	5.76	6.63	6.68	6.72	6.80	6.94	7.09	7.23	4.55	0.80
Other paid staff	3.33	33.30	7	0.03	1.92	2.76	5.07	7.68	8.89	10.71	12.22	13.72	16.51	21.84	27.17	32.50	9.78	-0.57
Total FTEs	9.93	33.30	7	5.00	8.60	9.40	10.23	10.68	14.14	16.71	17.09	17.47	19.78	25.94	32.09	38.25	15.04	-0.46
<i>Staff FTE / 1,000 pop</i>	0.80	50.00	7	0.41	0.67	0.69	0.74	0.80	0.86	0.94	1.00	1.06	1.20	1.49	1.77	2.06	0.94	-0.27
<i>MLS pct of total staff</i>	0.00%	0.00	7	0.00%	0.00%	0.00%	0.00%	0.00%	0.00%	1.05%	2.61%	4.18%	6.40%	9.91%	13.41%	16.92%	3.16%	-0.50

WYOMING LIBRARIES / 10,000 to 25,000 pop

	Converse Cty Libr	%ile rank	n=	Low	25th %ile	30th %ile	40th %ile	50th %ile	60th %ile	70th %ile	75th %ile	80th %ile	85th %ile	90th %ile	95th %ile	High	Average	z=
Revenue / Income (000s)																		
Local government	\$418	33.30	7	\$192	\$309	\$374	\$423	\$430	\$531	\$620	\$655	\$689	\$870	\$1,344	\$1,818	\$2,291	\$691	-0.37
State government	\$0	0.00	7	\$0	\$0	\$0	\$0	\$0	\$0	\$0	\$0	\$0	\$0	\$0	\$0	\$0	\$0	#####
Federal government	\$5	100.00	7	\$0	\$1	\$1	\$1	\$1	\$2	\$2	\$2	\$3	\$3	\$4	\$5	\$5	\$2	2.00
Other income	\$12	50.00	7	\$7	\$11	\$11	\$12	\$12	\$28	\$43	\$50	\$58	\$63	\$66	\$69	\$72	\$30	-0.68
Total income	\$435	33.30	7	\$202	\$322	\$390	\$462	\$503	\$567	\$638	\$681	\$723	\$912	\$1,394	\$1,875	\$2,357	\$724	-0.39
Revenue Analysis																		
Local as pct of total	95.99%	66.60	7	85.50%	94.75%	94.78%	95.22%	95.88%	95.95%	96.24%	96.61%	96.98%	97.31%	97.56%	97.81%	98.06%	94.60%	0.33
State as pct of total	0.00%	0.00	7	0.00%	0.00%	0.00%	0.00%	0.00%	0.00%	0.00%	0.00%	0.00%	0.00%	0.00%	0.00%	0.00%	0.00%	#####
Federal as pct of total	1.26%	100.00	7	0.00%	0.17%	0.19%	0.23%	0.26%	0.38%	0.50%	0.57%	0.64%	0.75%	0.92%	1.09%	1.26%	0.43%	1.93
Other as pct of total	2.75%	33.30	7	1.94%	2.70%	2.73%	3.02%	3.43%	4.23%	4.82%	4.91%	5.01%	5.99%	8.74%	11.49%	14.24%	4.98%	-0.53
Revenue per capita	\$35.01	50.00	7	\$16.51	\$25.66	\$29.93	\$33.67	\$35.01	\$36.79	\$38.57	\$39.45	\$40.34	\$49.51	\$75.27	\$101.04	\$126.80	\$44.08	-0.24
Expenditures (000s)																		
Salaries	\$195	33.30	7	\$118	\$159	\$180	\$212	\$239	\$277	\$318	\$341	\$365	\$465	\$722	\$978	\$1,234	\$370	-0.45
Benefits	\$52	33.30	7	\$20	\$45	\$49	\$54	\$57	\$67	\$84	\$100	\$117	\$166	\$280	\$395	\$509	\$125	-0.42
Total staff expense	\$247	33.30	7	\$138	\$204	\$230	\$267	\$296	\$376	\$435	\$442	\$449	\$582	\$969	\$1,356	\$1,743	\$495	-0.44
Materials	\$59	33.30	7	\$33	\$48	\$55	\$62	\$66	\$66	\$68	\$70	\$72	\$80	\$102	\$125	\$147	\$69	-0.26
Other expense	\$82	50.00	7	\$31	\$61	\$70	\$78	\$82	\$85	\$92	\$101	\$110	\$132	\$180	\$228	\$276	\$102	-0.24
Total operating expense	\$388	33.30	7	\$205	\$314	\$359	\$411	\$445	\$542	\$607	\$609	\$611	\$768	\$1,234	\$1,700	\$2,166	\$666	-0.41
Capital expense	\$0	0.00	7	\$0	\$0	\$0	\$0	\$0	\$12	\$20	\$22	\$24	\$26	\$29	\$32	\$35	\$11	-0.76
Expenditure analysis																		
Benefits as pct of staff	21.24%	50.00	7	14.52%	17.75%	18.70%	20.10%	21.24%	22.29%	24.23%	26.10%	27.96%	29.25%	29.39%	29.54%	29.68%	21.88%	-0.11
Sal & ben as pct of op	63.66%	0.00	7	63.66%	66.69%	66.74%	66.94%	67.17%	68.99%	71.12%	72.50%	73.88%	75.36%	77.06%	78.76%	80.46%	69.95%	-1.08
Matl exp as pct of op	15.19%	66.60	7	6.78%	10.90%	10.91%	12.04%	13.72%	14.60%	15.42%	15.77%	16.12%	16.52%	16.99%	17.47%	17.94%	13.11%	0.54
Expenditure per capita	\$31.22	66.60	7	\$16.76	\$25.23	\$27.49	\$29.64	\$30.62	\$30.98	\$33.20	\$36.17	\$39.14	\$48.66	\$71.30	\$93.93	\$116.56	\$40.96	-0.28
Mats exp per capita	\$4.74	66.60	7	\$2.95	\$3.17	\$3.28	\$3.79	\$4.47	\$4.63	\$4.74	\$4.74	\$4.74	\$5.06	\$6.01	\$6.96	\$7.90	\$4.45	0.17

U.S. LIBRARIES / 12,000 to 13,000 pop

	Converse Cty Libr	%ile rank	n=	Low	25th %ile	30th %ile	40th %ile	50th %ile	60th %ile	70th %ile	75th %ile	80th %ile	85th %ile	90th %ile	95th %ile	High	Average	z=	
Population	12,433	40.00	161	12,005	12,309	12,350	12,433	12,530	12,620	12,723	12,769	12,811	12,872	12,898	12,928	12,999	12,529	-0.35	
Configuration																			
Central	1	0.00	161	1	1	1	1	1	1	1	1	1	1	1	1	1	1	1	#####
Branch	1	87.50	161	0	0	0	0	0	0	0	0	0	0	1	2	3	0	1.30	
Bookmobile	0	0.00	161	0	0	0	0	0	0	0	0	0	0	0	1	1	0	-0.27	
Hours open	4,628	93.70	161	1,135	2,478	2,500	2,664	2,812	2,912	3,137	3,224	3,328	3,396	3,874	4,860	11,800	3,078	1.12	
Holdings																			
Volumes held	49,884	61.20	161	6,347	30,179	32,534	39,814	44,007	49,497	52,989	57,409	61,507	68,670	80,046	90,755	143,636	47,291	0.11	
Periodical subscriptions	139	67.50	161	0	74	82	93	104	116	142	150	166	177	190	214	389	112	0.42	
Audio recordings held	2,403	73.10	161	56	805	883	1,096	1,512	1,849	2,155	2,527	2,782	3,023	3,629	4,653	12,763	1,846	0.33	
Video recordings held	2,364	74.30	161	58	812	920	1,287	1,444	1,847	2,193	2,382	2,563	2,971	3,500	4,411	7,753	1,811	0.41	
Holdings analysis																			
<i>Volumes held per capita</i>	4.01	61.20	161	0.51	2.42	2.54	3.15	3.58	3.97	4.30	4.61	4.83	5.65	6.29	7.35	11.13	3.78	0.13	
<i>Subscrips per 1,000 pop</i>	11.18	70.60	161	0.00	5.87	6.46	7.49	8.29	9.42	11.16	12.16	13.19	13.98	15.30	16.85	31.14	8.94	0.44	
<i>Audios per 1,000 pop</i>	193.28	74.30	161	4.38	62.86	70.48	88.45	119.79	147.54	174.32	198.48	221.52	244.36	283.87	360.56	1,029.61	147.37	0.34	
<i>Videos per 1,000 pop</i>	190.14	75.00	161	4.52	64.84	72.30	102.32	115.10	148.25	174.50	190.14	205.37	234.92	272.18	352.78	633.42	144.57	0.43	
<i>Nonprint as pct of print</i>	9.56%	73.70	161	0.57%	5.01%	5.38%	6.40%	7.29%	8.40%	9.02%	9.62%	10.59%	11.52%	12.26%	13.67%	28.67%	7.73%	0.47	
Automation access																			
Internet PCs for public	18	86.80	161	0	6	6	7	8	10	12	13	14	17	19	25	53	10	0.99	
<i>Public PCs per 1,000 pop</i>	1.45	88.10	161	0.00	0.46	0.49	0.57	0.65	0.82	0.94	1.04	1.13	1.35	1.52	2.04	4.13	0.83	1.02	
<i>Public PCs per 1,000 visits</i>	0.24	61.80	161	0.00	0.09	0.12	0.15	0.17	0.22	0.28	0.30	0.37	0.44	0.64	1.05	3.00	0.30	-0.16	
<i>Public PCs per 1,000 vol</i>	0.36	78.10	161	0.00	0.12	0.13	0.17	0.21	0.26	0.29	0.33	0.37	0.43	0.49	0.71	2.37	0.28	0.29	
Internet PCs for staff																			
<i>Staff PCs per FTE</i>																			

U.S. LIBRARIES / 12,000 to 13,000 pop

	Converse Cty Libr	%ile rank	n=	Low	25th %ile	30th %ile	40th %ile	50th %ile	60th %ile	70th %ile	75th %ile	80th %ile	85th %ile	90th %ile	95th %ile	High	Average	z=
Circulation																		
Circulation	96,645	61.80	161	1,482	46,645	52,885	68,646	81,727	94,914	115,373	124,474	139,216	149,656	176,439	224,716	333,242	93,688	0.05
J circulation	31,449	55.00	161	360	15,000	18,505	23,994	30,147	33,472	39,244	43,501	48,669	55,258	66,944	93,596	117,076	33,994	-0.10
<i>J circ as pct of total</i>	32.54%	39.30	161	3.12%	27.90%	30.68%	32.57%	35.86%	39.20%	41.47%	43.76%	44.85%	46.76%	50.86%	57.03%	73.29%	35.97%	-0.29
<i>Circulation per capita</i>	7.77	62.50	161	0.11	3.71	4.36	5.53	6.63	7.40	9.47	10.12	10.81	11.96	13.73	17.64	27.26	7.48	0.06
<i>Circulation per visit</i>	1.27	33.10	161	0.06	1.10	1.21	1.34	1.57	1.76	2.01	2.10	2.28	3.09	3.42	4.70	6.15	1.86	-0.49
<i>Circ per item held</i>	1.94	55.60	161	0.09	1.26	1.46	1.65	1.83	2.12	2.33	2.55	2.68	2.89	3.12	3.59	5.60	1.95	-0.02
<i>Circ per FTE staff</i>	9,733	31.20	161	371	9,010	9,552	10,705	12,354	13,659	16,008	17,330	18,591	21,188	22,490	28,484	66,093	13,899	-0.50
<i>Expenditure per circ</i>	\$4.02	56.20	161	\$0.53	\$2.66	\$2.91	\$3.29	\$3.73	\$4.11	\$4.59	\$5.04	\$6.05	\$6.83	\$7.87	\$9.51	\$75.02	\$4.88	-0.14
Interlibrary loans																		
Loans to	1,004	61.20	161	0	7	22	136	321	991	2,365	3,928	5,056	6,873	8,720	12,881	33,748	2,958	-0.35
Loans from	302	35.00	161	0	113	176	399	570	1,015	2,502	3,337	4,348	5,887	8,676	13,998	32,866	2,889	-0.51
<i>Net lending</i>	702	86.20	161	-20,724	-477	-392	-203	-83	-27	1	76	335	649	1,785	3,350	29,494	68	0.16
Library visits																		
Library visits	76,317	72.50	161	4,503	28,799	32,400	43,264	53,244	61,237	73,060	79,950	86,154	92,812	102,440	131,872	324,587	60,067	0.36
<i>Library visits per capita</i>	6.14	72.50	161	0.35	2.23	2.60	3.39	4.33	4.99	5.86	6.37	6.83	7.27	8.19	10.49	25.16	4.80	0.37
Reference transactions																		
Reference transactions	11,055	73.10	161	152	2,711	3,500	4,678	6,084	7,476	9,633	11,500	13,192	17,498	22,095	28,000	465,348	11,415	-0.01
<i>Ref transac per capita</i>	0.89	73.10	161	0.01	0.22	0.27	0.37	0.49	0.60	0.77	0.92	1.04	1.39	1.80	2.25	37.80	0.91	-0.01
Staffing																		
MLS librarians	0.00	0.00	161	0.00	0.00	0.00	0.96	1.00	1.00	1.75	2.00	2.00	2.00	2.63	3.80	11.38	1.24	-0.81
Other librarians	6.60	98.10	161	0.00	0.00	0.75	1.00	1.00	1.00	2.18	2.98	3.00	4.00	4.81	5.25	8.90	1.76	2.50
Other paid staff	3.33	48.10	161	0.00	2.00	2.38	3.00	3.43	4.20	5.15	5.60	6.50	7.50	8.05	9.12	15.65	4.09	-0.26
Total FTEs	9.93	81.80	161	1.26	4.30	4.80	5.73	6.49	7.30	8.50	8.80	9.60	10.50	11.22	14.80	25.81	7.09	0.71
<i>Staff FTE / 1,000 pop</i>	0.80	83.10	161	0.10	0.35	0.39	0.46	0.53	0.59	0.67	0.70	0.76	0.85	0.91	1.16	2.00	0.57	0.73
<i>MLS pct of total staff</i>	0.00%	0.00	161	0.00%	0.00%	0.00%	10.20%	13.46%	19.16%	24.15%	25.97%	30.87%	34.09%	37.50%	44.09%	71.97%	16.19%	-1.03

U.S. LIBRARIES / 12,000 to 13,000 pop

	Converse Cty Libr	%ile rank	n=	Low	25th %ile	30th %ile	40th %ile	50th %ile	60th %ile	70th %ile	75th %ile	80th %ile	85th %ile	90th %ile	95th %ile	High	Average	z=
Revenue / Income (000s)																		
Local government	\$418	76.20	161	\$0	\$108	\$129	\$157	\$219	\$297	\$368	\$398	\$436	\$471	\$574	\$642	\$1,720	\$281	0.51
State government	\$0	0.00	161	\$0	\$3	\$4	\$8	\$11	\$15	\$19	\$30	\$41	\$54	\$86	\$429	\$783	\$54	-0.40
Federal government	\$5	93.10	161	\$0	\$0	\$0	\$0	\$0	\$0	\$0	\$0	\$1	\$2	\$4	\$7	\$98	\$2	0.45
Other income	\$12	26.20	161	\$0	\$11	\$14	\$19	\$24	\$29	\$38	\$43	\$50	\$59	\$78	\$137	\$425	\$39	-0.49
Total income	\$435	65.00	161	\$23	\$184	\$202	\$259	\$334	\$408	\$472	\$509	\$545	\$592	\$666	\$703	\$1,759	\$376	0.22
Revenue Analysis																		
Local as pct of total	95.99%	86.20	161	0.00%	63.66%	71.40%	82.75%	87.16%	91.19%	93.61%	94.44%	95.08%	95.61%	96.54%	97.53%	100.00%	73.94%	0.76
State as pct of total	0.00%	0.00	161	0.00%	1.15%	1.79%	2.23%	2.78%	4.74%	8.18%	14.34%	17.15%	26.31%	45.90%	91.99%	96.68%	13.69%	-0.56
Federal as pct of total	1.26%	89.30	161	0.00%	0.00%	0.00%	0.00%	0.00%	0.00%	0.00%	0.00%	0.21%	0.52%	1.51%	2.29%	18.16%	0.54%	0.34
Other as pct of total	2.75%	17.50	161	0.00%	3.42%	4.09%	5.32%	6.83%	8.21%	11.66%	13.96%	18.03%	22.04%	29.44%	40.76%	99.88%	11.83%	-0.64
Revenue per capita	\$35.01	64.30	161	\$1.78	\$14.69	\$16.11	\$21.40	\$26.80	\$32.46	\$37.43	\$40.27	\$43.50	\$46.63	\$52.76	\$58.30	\$136.37	\$29.99	0.24
Expenditures (000s)																		
Salaries	\$195	55.30	151	\$36	\$96	\$111	\$126	\$160	\$211	\$237	\$253	\$277	\$303	\$349	\$408	\$1,055	\$196	-0.01
Benefits	\$52	72.00	151	\$0	\$16	\$19	\$24	\$31	\$37	\$50	\$57	\$65	\$76	\$97	\$117	\$250	\$42	0.26
Total staff expense	\$247	58.00	151	\$43	\$115	\$132	\$154	\$183	\$256	\$287	\$310	\$343	\$373	\$423	\$507	\$1,305	\$238	0.05
Materials	\$59	68.10	161	\$0	\$23	\$26	\$32	\$40	\$48	\$61	\$64	\$68	\$78	\$89	\$126	\$268	\$50	0.23
Other expense	\$82	65.30	151	\$0	\$37	\$42	\$52	\$63	\$74	\$92	\$101	\$112	\$123	\$138	\$175	\$384	\$76	0.12
Total operating expense	\$388	62.50	161	\$20	\$181	\$198	\$231	\$300	\$368	\$438	\$474	\$501	\$517	\$608	\$764	\$1,724	\$348	0.16
Capital expense	\$0	0.00	161	\$0	\$0	\$0	\$0	\$5	\$13	\$29	\$41	\$52	\$102	\$183	\$337	\$2,500	\$77	-0.30
Expenditure analysis																		
Benefits as pct of staff	21.24%	70.00	151	0.00%	12.50%	13.75%	15.53%	17.43%	19.30%	21.24%	21.68%	23.72%	26.25%	27.86%	30.92%	43.54%	17.09%	0.48
Sal & ben as pct of op	63.66%	48.60	151	41.02%	58.56%	59.95%	61.61%	64.30%	66.75%	68.79%	70.53%	71.94%	73.52%	75.61%	78.14%	92.41%	63.97%	-0.03
Matl exp as pct of op	15.19%	56.20	161	2.41%	11.56%	12.00%	12.86%	14.16%	15.64%	17.24%	17.94%	18.42%	19.28%	20.72%	22.53%	27.44%	14.42%	0.15
Expenditure per capita	\$31.22	63.10	161	\$1.56	\$14.33	\$15.80	\$18.36	\$24.24	\$28.67	\$34.61	\$36.97	\$39.89	\$42.18	\$49.26	\$60.74	\$133.61	\$27.75	0.17
Mats exp per capita	\$4.74	68.10	161	\$0.04	\$1.85	\$2.00	\$2.56	\$3.17	\$3.86	\$4.88	\$5.12	\$5.51	\$6.26	\$7.20	\$9.81	\$20.78	\$3.97	0.24

U.S. LIBRARIES / 14,000 to 16,000 pop

	Converse Cty Libr	%ile rank	n=	Low	25th %ile	30th %ile	40th %ile	50th %ile	60th %ile	70th %ile	75th %ile	80th %ile	85th %ile	90th %ile	95th %ile	High	Average	z=	
Population	12,433	#N/A	272	14,000	14,428	14,521	14,773	15,041	15,291	15,420	15,524	15,594	15,666	15,796	15,883	15,976	14,992	-4.25	
Configuration																			
Central	1	1.10	272	0	1	1	1	1	1	1	1	1	1	1	1	1	1	1	0.11
Branch	1	87.00	272	0	0	0	0	0	0	0	0	0	0	1	2	12	0	0.57	
Bookmobile	0	0.00	272	0	0	0	0	0	0	0	0	0	0	0	1	1	0	-0.27	
Hours open	4,628	92.70	272	350	2,478	2,558	2,702	2,842	3,000	3,120	3,270	3,328	3,519	4,095	5,889	9,282	3,100	1.19	
Holdings																			
Volumes held	49,884	48.00	272	8,314	34,743	38,248	45,007	51,052	58,412	63,567	67,101	71,298	77,363	89,039	98,330	144,420	53,722	-0.15	
Periodical subscriptions	139	57.10	272	0	68	73	93	120	142	162	177	185	201	229	273	649	127	0.14	
Audio recordings held	2,403	64.80	272	0	917	1,108	1,417	1,767	2,115	2,658	2,943	3,215	3,550	4,299	5,542	16,080	2,227	0.09	
Video recordings held	2,364	57.10	272	0	984	1,153	1,664	2,020	2,450	2,785	3,021	3,396	4,036	4,507	5,250	10,481	2,283	0.05	
Holdings analysis																			
<i>Volumes held per capita</i>	4.01	60.70	272	0.59	2.27	2.57	2.95	3.32	3.99	4.21	4.59	4.86	5.17	5.90	6.53	9.49	3.58	0.25	
<i>Subscrips per 1,000 pop</i>	11.18	72.20	272	0.00	4.63	4.88	6.09	8.06	9.46	10.73	11.84	12.61	13.76	14.86	17.95	41.77	8.51	0.49	
<i>Audios per 1,000 pop</i>	193.28	73.90	272	0.00	61.00	73.94	94.83	114.95	144.21	177.37	196.89	213.00	245.96	277.88	371.90	1,034.95	148.62	0.33	
<i>Videos per 1,000 pop</i>	190.14	70.70	272	0.00	66.91	76.51	112.24	135.81	162.65	188.92	199.81	235.73	266.44	294.58	351.93	680.15	152.30	0.34	
<i>Nonprint as pct of print</i>	9.56%	64.40	272	0.03%	5.21%	5.70%	6.54%	7.52%	8.61%	10.21%	10.72%	11.42%	12.79%	14.08%	17.19%	22.86%	8.36%	0.27	
Automation access																			
Internet PCs for public	18	84.80	272	0	6	6	8	9	11	13	14	15	18	21	24	50	11	1.03	
<i>Public PCs per 1,000 pop</i>	1.45	91.30	272	0.00	0.39	0.41	0.51	0.58	0.70	0.84	0.94	1.04	1.21	1.39	1.60	3.14	0.72	1.55	
<i>Public PCs per 1,000 visits</i>	0.24	75.60	272	0.00	0.08	0.09	0.12	0.14	0.17	0.21	0.23	0.26	0.31	0.39	0.51	8.65	0.22	0.03	
<i>Public PCs per 1,000 vol</i>	0.36	84.50	272	0.00	0.12	0.13	0.16	0.19	0.22	0.26	0.29	0.33	0.37	0.43	0.53	1.64	0.23	0.79	
Internet PCs for staff																			
<i>Staff PCs per FTE</i>																			

U.S. LIBRARIES / 14,000 to 16,000 pop

	Converse Cty Libr	%ile rank	n=	Low	25th %ile	30th %ile	40th %ile	50th %ile	60th %ile	70th %ile	75th %ile	80th %ile	85th %ile	90th %ile	95th %ile	High	Average	z=
Circulation																		
Circulation	96,645	48.60	272	687	60,101	66,375	82,377	99,257	117,336	140,225	154,451	169,896	191,288	219,753	256,967	703,233	115,684	-0.24
J circulation	31,449	49.10	272	241	20,675	22,656	27,366	31,766	38,805	48,946	56,022	63,729	75,255	87,579	108,201	398,200	42,809	-0.30
<i>J circ as pct of total</i>	32.54%	38.10	272	5.83%	28.84%	30.00%	32.81%	35.11%	38.22%	41.92%	43.01%	44.56%	46.90%	50.01%	55.82%	77.90%	36.19%	-0.33
<i>Circulation per capita</i>	7.77	60.30	272	0.04	4.05	4.53	5.36	6.50	7.66	9.39	10.31	11.28	12.51	14.61	17.47	49.16	7.74	0.01
<i>Circulation per visit</i>	1.27	40.00	272	0.23	1.06	1.13	1.26	1.37	1.52	1.73	1.94	2.08	2.27	2.71	3.41	11.38	1.66	-0.33
<i>Circ per item held</i>	1.94	47.80	272	0.01	1.37	1.48	1.77	1.97	2.21	2.58	2.75	3.07	3.29	3.89	5.01	8.16	2.23	-0.23
<i>Circ per FTE staff</i>	9,733	28.60	272	548	8,986	9,838	11,291	12,471	14,942	17,324	18,427	19,420	20,429	23,030	26,621	78,926	14,433	-0.56
<i>Expenditure per circ</i>	\$4.02	59.30	272	\$0.60	\$2.64	\$2.95	\$3.29	\$3.65	\$4.04	\$4.86	\$5.14	\$5.55	\$6.09	\$7.54	\$8.87	\$93.76	\$4.62	-0.10
Interlibrary loans																		
Loans to	1,004	58.50	272	0	32	96	271	627	1,129	3,130	3,981	4,908	7,115	14,605	21,041	76,038	4,187	-0.36
Loans from	302	27.10	272	0	266	353	534	843	1,661	3,107	3,920	4,965	7,050	9,945	17,791	65,957	3,758	-0.47
<i>Net lending</i>	702	84.80	272	-9,804	-550	-441	-261	-128	-46	34	220	348	735	1,821	6,564	29,358	430	0.07
Library visits																		
Library visits	76,317	57.60	272	804	41,198	47,870	57,581	66,204	78,000	93,637	100,201	119,315	140,730	165,967	203,779	545,350	84,522	-0.12
<i>Library visits per capita</i>	6.14	68.60	272	0.05	2.76	3.24	3.79	4.50	5.22	6.28	6.78	8.06	9.64	11.05	13.66	34.17	5.63	0.11
Reference transactions																		
Reference transactions	11,055	64.60	272	120	3,454	4,548	6,153	8,120	10,434	12,463	14,355	16,977	21,402	25,958	33,770	72,280	11,571	-0.04
<i>Ref transac per capita</i>	0.89	73.80	272	0.01	0.23	0.29	0.43	0.54	0.69	0.84	0.97	1.13	1.42	1.73	2.39	4.75	0.77	0.14
Staffing																		
MLS librarians	0.00	0.00	272	0.00	0.00	0.00	1.00	1.00	1.30	2.00	2.31	2.80	3.00	4.28	5.40	11.30	1.63	-0.86
Other librarians	6.60	97.10	272	0.00	0.00	0.54	1.00	1.00	1.51	2.00	2.61	3.00	3.81	4.50	5.54	9.38	1.72	2.57
Other paid staff	3.33	35.50	272	0.00	2.29	2.80	3.79	4.36	5.28	6.33	6.91	7.66	8.52	9.59	13.56	33.69	5.22	-0.45
Total FTEs	9.93	69.30	272	0.20	5.00	5.54	6.44	7.50	8.69	10.00	10.69	11.57	12.55	14.12	18.55	41.57	8.57	0.25
<i>Staff FTE / 1,000 pop</i>	0.80	81.80	272	0.01	0.34	0.38	0.43	0.50	0.58	0.67	0.72	0.77	0.84	0.97	1.25	2.68	0.57	0.64
<i>MLS pct of total staff</i>	0.00%	0.00	272	0.00%	0.00%	0.00%	11.94%	16.67%	20.16%	24.69%	28.67%	32.34%	34.80%	38.55%	42.29%	100.00%	17.36%	-1.10

U.S. LIBRARIES / 14,000 to 16,000 pop

	Converse Cty Libr	%ile rank	n=	Low	25th %ile	30th %ile	40th %ile	50th %ile	60th %ile	70th %ile	75th %ile	80th %ile	85th %ile	90th %ile	95th %ile	High	Average	z=
Revenue / Income (000s)																		
Local government	\$418	70.60	272	\$0	\$148	\$177	\$240	\$278	\$345	\$409	\$469	\$535	\$602	\$762	\$959	\$2,798	\$382	0.08
State government	\$0	0.00	272	\$0	\$3	\$4	\$6	\$13	\$17	\$20	\$29	\$38	\$60	\$83	\$414	\$733	\$50	-0.39
Federal government	\$5	90.30	272	\$0	\$0	\$0	\$0	\$0	\$0	\$0	\$0	\$0	\$2	\$5	\$10	\$34	\$2	0.69
Other income	\$12	27.80	272	\$0	\$11	\$14	\$18	\$25	\$34	\$46	\$58	\$63	\$79	\$99	\$150	\$825	\$48	-0.43
Total income	\$435	57.10	272	\$3	\$224	\$267	\$300	\$368	\$454	\$541	\$595	\$626	\$745	\$866	\$1,128	\$2,895	\$482	-0.11
Revenue Analysis																		
Local as pct of total	95.99%	85.00	272	0.00%	73.38%	77.76%	84.11%	88.32%	91.19%	93.26%	94.28%	94.93%	95.98%	97.67%	98.84%	100.00%	76.42%	0.70
State as pct of total	0.00%	0.00	272	0.00%	0.52%	1.02%	1.85%	2.46%	4.38%	6.50%	7.95%	14.36%	24.24%	46.42%	64.27%	95.76%	11.76%	-0.54
Federal as pct of total	1.26%	87.90	272	0.00%	0.00%	0.00%	0.00%	0.00%	0.00%	0.00%	0.00%	0.02%	0.55%	1.58%	4.70%	14.12%	0.61%	0.33
Other as pct of total	2.75%	20.70	272	0.00%	3.21%	3.54%	4.90%	5.69%	7.84%	11.19%	13.87%	16.75%	19.50%	27.01%	39.95%	97.74%	11.21%	-0.59
Revenue per capita	\$35.01	67.20	272	\$0.21	\$15.44	\$17.83	\$20.23	\$24.35	\$30.49	\$36.40	\$38.66	\$43.46	\$49.52	\$58.59	\$73.75	\$204.77	\$32.16	0.10
Expenditures (000s)																		
Salaries	\$195	48.40	264	\$36	\$116	\$132	\$162	\$199	\$232	\$275	\$299	\$325	\$367	\$417	\$556	\$1,715	\$244	-0.23
Benefits	\$52	62.20	264	\$0	\$17	\$21	\$29	\$38	\$50	\$62	\$72	\$82	\$95	\$108	\$127	\$456	\$53	-0.01
Total staff expense	\$247	52.30	264	\$43	\$140	\$154	\$197	\$239	\$297	\$337	\$363	\$392	\$431	\$517	\$668	\$2,072	\$297	-0.19
Materials	\$59	60.50	272	\$0	\$29	\$33	\$41	\$49	\$58	\$76	\$83	\$89	\$106	\$127	\$152	\$400	\$64	-0.09
Other expense	\$82	56.10	264	\$0	\$40	\$46	\$58	\$73	\$88	\$107	\$116	\$124	\$140	\$169	\$256	\$1,004	\$97	-0.14
Total operating expense	\$388	53.50	272	\$3	\$210	\$242	\$287	\$354	\$422	\$510	\$540	\$596	\$668	\$816	\$1,088	\$2,821	\$448	-0.15
Capital expense	\$0	0.00	272	\$0	\$0	\$0	\$0	\$3	\$9	\$19	\$28	\$42	\$59	\$99	\$390	\$2,600	\$74	-0.26
Expenditure analysis																		
Benefits as pct of staff	21.24%	66.70	264	0.00%	12.20%	13.57%	15.52%	18.12%	19.91%	21.76%	22.66%	23.50%	24.86%	26.09%	29.42%	46.88%	16.97%	0.51
Sal & ben as pct of op	63.66%	46.10	264	42.14%	59.23%	60.31%	62.40%	64.39%	66.69%	68.80%	70.35%	71.40%	73.07%	75.49%	79.57%	85.62%	64.50%	-0.10
Matl exp as pct of op	15.19%	57.30	272	0.00%	10.99%	11.73%	13.03%	14.32%	15.81%	17.23%	17.90%	19.47%	20.18%	21.55%	23.69%	33.77%	14.87%	0.06
Expenditure per capita	\$31.22	63.90	272	\$0.21	\$14.41	\$15.75	\$19.09	\$23.90	\$28.25	\$34.17	\$36.34	\$40.01	\$44.40	\$54.82	\$72.87	\$200.97	\$29.87	0.05
Mats exp per capita	\$4.74	68.60	272	\$0.00	\$1.96	\$2.23	\$2.72	\$3.26	\$4.00	\$4.90	\$5.39	\$6.14	\$7.01	\$8.53	\$10.28	\$26.00	\$4.27	0.13

U.S. COUNTY LIBRARIES / 11,000 to 14,000 pop

	Converse Cty Libr	%ile rank	n=	Low	25th %ile	30th %ile	40th %ile	50th %ile	60th %ile	70th %ile	75th %ile	80th %ile	85th %ile	90th %ile	95th %ile	High	Average	z=
Population	12,433	40.40	48	11,162	11,841	12,041	12,407	12,661	12,825	13,077	13,157	13,272	13,311	13,583	13,753	13,999	12,542	-0.13
Configuration																		
Central	1	6.30	48	0	1	1	1	1	1	1	1	1	1	1	1	1	1	0.26
Branch	1	61.70	48	0	0	0	0	0	0	1	2	2	2	2	4	6	1	0.07
Bookmobile	0	0.00	48	0	0	0	0	0	0	0	0	0	1	1	1	1	0	-0.44
Hours open	4,628	82.90	48	1,620	2,360	2,444	2,600	2,808	3,003	3,640	3,799	4,541	4,900	5,577	6,754	11,800	3,467	0.62
Holdings																		
Volumes held	49,884	72.30	48	6,347	24,748	26,633	30,452	34,919	39,080	49,640	51,833	55,130	61,998	72,172	92,700	113,925	41,096	0.36
Periodical subscriptions	139	82.90	48	0	40	42	59	64	76	101	116	128	147	199	265	2,181	130	0.03
Audio recordings held	2,403	80.80	48	66	394	454	564	715	942	1,318	1,706	2,263	2,702	2,991	3,784	24,118	1,645	0.22
Video recordings held	2,364	87.20	48	36	544	592	815	1,042	1,246	1,783	1,927	2,050	2,312	3,073	3,378	4,807	1,357	0.92
Holdings analysis																		
<i>Volumes held per capita</i>	4.01	74.40	48	0.51	2.05	2.13	2.36	2.80	3.06	3.85	4.01	4.31	5.10	6.02	7.67	10.16	3.29	0.36
<i>Subscrips per 1,000 pop</i>	11.18	85.10	48	0.00	3.10	3.49	4.45	5.11	5.92	8.28	9.94	10.46	11.16	15.63	21.01	163.37	10.09	0.05
<i>Audios per 1,000 pop</i>	193.28	82.90	48	5.27	33.80	34.94	43.65	56.74	73.92	112.69	137.36	189.11	221.13	236.04	281.06	2,010.84	131.89	0.21
<i>Videos per 1,000 pop</i>	190.14	85.10	48	2.75	43.06	51.35	62.49	86.97	104.53	143.53	148.44	178.15	189.64	246.18	254.40	354.81	108.18	0.96
<i>Nonprint as pct of print</i>	9.56%	76.50	48	0.49%	3.75%	4.49%	5.21%	6.15%	6.93%	8.46%	9.03%	9.98%	10.27%	11.13%	15.33%	30.38%	7.03%	0.49
Automation access																		
Internet PCs for public	18	85.10	48	2	5	6	7	8	8	11	11	13	18	22	27	41	10	0.96
<i>Public PCs per 1,000 pop</i>	1.45	85.10	48	0.15	0.44	0.46	0.53	0.60	0.70	0.85	0.89	1.04	1.43	1.81	2.13	3.07	0.82	1.00
<i>Public PCs per 1,000 visits</i>	0.24	48.90	48	0.03	0.14	0.14	0.21	0.24	0.28	0.37	0.40	0.43	0.55	0.65	0.69	3.00	0.34	-0.24
<i>Public PCs per 1,000 vol</i>	0.36	74.40	48	0.04	0.15	0.17	0.20	0.22	0.27	0.34	0.37	0.40	0.47	0.49	0.53	1.49	0.29	0.31
Internet PCs for staff																		
<i>Staff PCs per FTE</i>																		

U.S. COUNTY LIBRARIES / 11,000 to 14,000 pop

	Converse Cty Libr	%ile rank	n=	Low	25th %ile	30th %ile	40th %ile	50th %ile	60th %ile	70th %ile	75th %ile	80th %ile	85th %ile	90th %ile	95th %ile	High	Average	z=
Circulation																		
Circulation	96,645	82.90	48	10,829	29,111	31,090	36,278	45,259	56,777	81,430	84,575	95,095	97,967	111,953	153,822	227,227	61,349	0.75
J circulation	31,449	82.90	48	360	6,555	8,197	10,717	16,122	19,010	22,227	23,000	28,330	33,626	41,701	53,337	63,079	18,908	0.81
<i>J circ as pct of total</i>	32.54%	63.80	48	3.12%	22.63%	23.15%	26.97%	28.71%	31.70%	34.34%	37.95%	42.31%	44.83%	49.22%	50.75%	59.52%	30.60%	0.16
<i>Circulation per capita</i>	7.77	87.20	48	0.81	2.40	2.44	2.81	3.80	4.32	6.39	6.87	7.30	7.57	9.50	11.95	16.63	4.88	0.79
<i>Circulation per visit</i>	1.27	42.50	48	0.22	1.00	1.11	1.24	1.30	1.42	1.60	1.69	1.99	2.15	2.52	3.13	4.70	1.54	-0.31
<i>Circ per item held</i>	1.94	76.50	48	0.27	1.00	1.05	1.15	1.36	1.59	1.88	1.93	2.18	2.33	2.48	2.86	5.40	1.55	0.43
<i>Circ per FTE staff</i>	9,733	36.10	48	1,650	8,476	9,047	10,367	10,878	12,104	12,911	13,772	14,668	15,825	17,387	21,622	34,733	11,535	-0.30
<i>Expenditure per circ</i>	\$4.02	57.40	48	\$1.15	\$2.84	\$3.01	\$3.36	\$3.67	\$4.30	\$5.35	\$5.63	\$5.87	\$6.60	\$8.18	\$12.46	\$19.13	\$4.83	-0.23
Interlibrary loans																		
Loans to	1,004	87.20	48	0	0	0	3	14	55	146	264	450	647	1,345	3,305	46,943	1,354	-0.05
Loans from	302	61.70	48	2	61	82	100	199	269	439	534	783	851	1,283	2,294	60,439	1,712	-0.16
<i>Net lending</i>	702	93.60	48	-13,496	-228	-211	-97	-61	-43	-30	-17	21	86	263	750	2,878	-358	0.51
Library visits																		
Library visits	76,317	82.90	48	7,269	18,104	20,285	25,786	33,407	42,276	59,844	67,288	73,598	89,072	96,200	146,084	300,645	51,302	0.47
<i>Library visits per capita</i>	6.14	80.80	48	0.55	1.52	1.58	2.17	2.76	3.36	4.63	5.30	5.94	6.74	7.37	11.21	25.07	4.07	0.49
Reference transactions																		
Reference transactions	11,055	82.90	48	400	1,736	2,081	2,875	3,829	5,601	8,107	8,565	10,847	11,445	14,236	19,675	38,880	6,583	0.60
<i>Ref transac per capita</i>	0.89	80.80	48	0.03	0.14	0.17	0.23	0.32	0.46	0.65	0.69	0.87	0.92	1.08	1.50	3.12	0.52	0.62
Staffing																		
MLS librarians	0.00	0.00	48	0.00	0.00	0.00	0.00	0.00	0.19	1.00	1.00	1.00	1.00	2.00	2.87	11.00	0.80	-0.45
Other librarians	6.60	97.80	48	0.00	0.87	1.00	1.00	1.00	1.20	2.77	2.92	3.00	3.95	4.15	4.91	7.23	1.85	2.70
Other paid staff	3.33	61.70	48	0.00	1.00	1.01	1.99	2.38	3.27	3.87	4.60	5.04	5.98	6.44	8.10	15.00	3.25	0.02
Total FTEs	9.93	93.60	48	0.80	3.44	3.61	4.50	5.00	5.90	6.86	7.06	7.70	8.74	9.11	11.15	25.18	5.91	0.92
<i>Staff FTE / 1,000 pop</i>	0.80	93.60	48	0.07	0.27	0.32	0.35	0.40	0.47	0.54	0.56	0.63	0.68	0.72	0.85	1.84	0.47	0.99
<i>MLS pct of total staff</i>	0.00%	0.00	48	0.00%	0.00%	0.00%	0.00%	0.00%	2.21%	16.94%	18.04%	21.94%	23.20%	25.13%	28.60%	43.69%	8.92%	-0.73

U.S. COUNTY LIBRARIES / 11,000 to 14,000 pop

	Converse Cty Libr	%ile rank	n=	Low	25th %ile	30th %ile	40th %ile	50th %ile	60th %ile	70th %ile	75th %ile	80th %ile	85th %ile	90th %ile	95th %ile	High	Average	z=
Revenue / Income (000s)																		
Local government	\$418	82.90	48	\$20	\$67	\$74	\$100	\$135	\$157	\$211	\$250	\$350	\$433	\$477	\$646	\$1,784	\$228	0.64
State government	\$0	0.00	48	\$0	\$0	\$0	\$2	\$6	\$11	\$17	\$21	\$30	\$39	\$43	\$80	\$429	\$24	-0.37
Federal government	\$5	87.20	48	\$0	\$0	\$0	\$0	\$0	\$0	\$0	\$1	\$3	\$5	\$6	\$11	\$102	\$4	0.06
Other income	\$12	63.80	48	\$0	\$3	\$4	\$6	\$9	\$12	\$20	\$25	\$34	\$37	\$62	\$196	\$250	\$30	-0.31
Total income	\$435	80.80	48	\$44	\$107	\$117	\$138	\$169	\$209	\$279	\$356	\$432	\$476	\$588	\$805	\$1,936	\$287	0.45
Revenue Analysis																		
Local as pct of total	95.99%	82.90	48	5.90%	72.04%	77.64%	82.32%	85.39%	91.90%	94.95%	95.42%	95.81%	96.56%	97.39%	98.55%	99.27%	78.17%	0.73
State as pct of total	0.00%	0.00	48	0.00%	0.00%	0.00%	1.70%	2.38%	3.05%	7.67%	14.49%	18.16%	20.58%	31.45%	50.70%	65.20%	10.09%	-0.61
Federal as pct of total	1.26%	80.80	48	0.00%	0.00%	0.00%	0.00%	0.00%	0.00%	0.00%	0.72%	1.13%	2.43%	4.95%	11.12%	15.03%	1.51%	-0.07
Other as pct of total	2.75%	27.60	48	0.00%	1.97%	3.15%	4.25%	6.06%	7.11%	11.44%	12.27%	13.38%	19.17%	21.38%	31.60%	69.69%	10.23%	-0.53
Revenue per capita	\$35.01	80.80	48	\$3.49	\$8.33	\$9.29	\$10.80	\$13.95	\$17.72	\$21.12	\$30.71	\$33.88	\$36.17	\$44.14	\$60.46	\$161.39	\$22.67	0.47
Expenditures (000s)																		
Salaries	\$195	74.30	40	\$33	\$67	\$76	\$87	\$96	\$120	\$148	\$197	\$212	\$237	\$321	\$479	\$1,255	\$174	0.09
Benefits	\$52	74.30	40	\$4	\$20	\$21	\$23	\$30	\$37	\$49	\$54	\$66	\$73	\$105	\$168	\$455	\$55	-0.03
Total staff expense	\$247	74.30	40	\$36	\$87	\$103	\$111	\$116	\$155	\$198	\$253	\$294	\$318	\$392	\$611	\$1,709	\$229	0.06
Materials	\$59	89.30	48	\$3	\$12	\$15	\$18	\$22	\$30	\$41	\$44	\$49	\$53	\$60	\$100	\$260	\$37	0.47
Other expense	\$82	79.40	40	\$5	\$23	\$24	\$28	\$38	\$51	\$73	\$77	\$84	\$101	\$138	\$174	\$1,158	\$89	-0.03
Total operating expense	\$388	78.70	48	\$37	\$106	\$112	\$133	\$167	\$224	\$257	\$314	\$398	\$440	\$490	\$757	\$3,079	\$312	0.15
Capital expense	\$0	0.00	48	\$0	\$0	\$0	\$0	\$0	\$2	\$4	\$16	\$23	\$40	\$50	\$85	\$1,874	\$58	-0.21
Expenditure analysis																		
Benefits as pct of staff	21.24%	38.40	40	7.64%	17.88%	18.26%	21.35%	21.87%	23.97%	26.87%	28.17%	30.91%	32.42%	33.54%	36.72%	44.12%	23.34%	-0.24
Sal & ben as pct of op	63.66%	38.40	40	47.91%	59.95%	61.49%	64.06%	66.98%	68.00%	71.89%	73.37%	74.93%	75.70%	76.28%	77.98%	79.36%	65.82%	-0.24
Matl exp as pct of op	15.19%	65.90	48	3.73%	9.23%	9.93%	12.50%	14.00%	14.70%	15.54%	17.38%	17.65%	17.87%	18.13%	19.72%	23.42%	13.12%	0.42
Expenditure per capita	\$31.22	80.80	48	\$3.34	\$8.25	\$8.98	\$10.51	\$13.94	\$18.19	\$20.77	\$27.10	\$30.88	\$34.70	\$37.15	\$56.13	\$225.31	\$24.46	0.18
Mats exp per capita	\$4.74	89.30	48	\$0.22	\$0.96	\$1.22	\$1.36	\$1.89	\$2.37	\$3.20	\$3.55	\$3.75	\$4.07	\$4.79	\$7.63	\$21.67	\$2.92	0.48

U.S. COUNTY LIBRARIES / 13,000 to 17,000 pop

	Converse Cty Libr	%ile rank	n=	Low	25th %ile	30th %ile	40th %ile	50th %ile	60th %ile	70th %ile	75th %ile	80th %ile	85th %ile	90th %ile	95th %ile	High	Average	z=	
Population	12,433	#N/A	53	13,060	13,781	14,107	14,520	14,897	15,350	15,697	15,862	16,073	16,472	16,703	16,835	16,996	14,928	-2.01	
Configuration																			
Central	1	11.50	53	0	1	1	1	1	1	1	1	1	1	1	1	1	1	1	0.35
Branch	1	51.90	53	0	0	0	0	0	1	1	2	2	2	3	5	7	1	-0.11	
Bookmobile	0	0.00	53	0	0	0	0	0	0	0	0	1	1	1	1	1	0	-0.56	
Hours open	4,628	73.60	53	1,620	2,326	2,540	2,717	3,000	3,518	4,455	4,784	5,453	6,190	7,254	7,949	9,282	3,852	0.39	
Holdings																			
Volumes held	49,884	59.70	53	13,038	30,126	30,473	36,727	42,048	50,188	56,493	61,755	63,137	66,625	71,143	97,719	111,500	46,169	0.16	
Periodical subscriptions	139	72.80	53	0	42	45	55	66	80	122	147	154	187	227	275	2,181	134	0.02	
Audio recordings held	2,403	84.40	53	170	575	586	883	1,158	1,652	1,897	2,135	2,219	2,435	2,944	3,456	4,232	1,439	0.91	
Video recordings held	2,364	72.30	53	36	783	842	1,054	1,214	1,672	2,035	2,631	2,748	3,321	3,845	4,822	6,102	1,765	0.41	
Holdings analysis																			
<i>Volumes held per capita</i>	4.01	73.70	53	0.90	1.84	2.07	2.65	2.89	3.28	3.98	4.04	4.09	4.60	4.85	6.14	7.58	3.12	0.54	
<i>Subscrips per 1,000 pop</i>	11.18	83.10	53	0.00	2.82	2.96	3.30	4.71	5.22	8.06	9.79	10.39	12.72	15.38	18.38	163.37	9.36	0.08	
<i>Audios per 1,000 pop</i>	193.28	88.40	53	12.77	38.07	42.75	55.62	81.49	113.49	126.54	135.08	149.54	153.78	219.58	250.03	321.87	97.85	1.25	
<i>Videos per 1,000 pop</i>	190.14	81.30	53	2.75	50.07	53.27	69.35	84.34	104.29	146.96	167.69	177.64	224.63	256.72	341.45	370.78	118.25	0.73	
<i>Nonprint as pct of print</i>	9.56%	78.70	53	0.49%	4.55%	4.92%	5.15%	6.14%	6.56%	7.76%	8.48%	9.86%	10.31%	14.00%	15.86%	19.25%	7.06%	0.61	
Automation access																			
Internet PCs for public	18	94.60	53	1	5	6	6	8	10	11	12	12	13	15	20	41	10	1.15	
<i>Public PCs per 1,000 pop</i>	1.45	95.30	53	0.07	0.36	0.37	0.46	0.54	0.68	0.76	0.79	0.81	0.88	0.94	1.36	3.07	0.65	1.57	
<i>Public PCs per 1,000 visits</i>	0.24	58.10	53	0.01	0.13	0.14	0.17	0.22	0.25	0.29	0.30	0.36	0.41	0.49	0.66	1.10	0.26	-0.11	
<i>Public PCs per 1,000 vol</i>	0.36	83.20	53	0.02	0.14	0.15	0.17	0.19	0.23	0.27	0.29	0.32	0.39	0.41	0.48	0.72	0.23	0.91	
Internet PCs for staff																			
<i>Staff PCs per FTE</i>																			

U.S. COUNTY LIBRARIES / 13,000 to 17,000 pop

	Converse Cty Libr	%ile rank	n=	Low	25th %ile	30th %ile	40th %ile	50th %ile	60th %ile	70th %ile	75th %ile	80th %ile	85th %ile	90th %ile	95th %ile	High	Average	z=
Circulation																		
Circulation	96,645	65.90	53	8,427	34,590	41,444	60,121	76,984	83,303	101,458	102,546	105,311	128,584	149,486	169,473	227,227	78,560	0.36
J circulation	31,449	75.40	53	491	9,657	14,175	20,207	22,513	23,792	28,993	30,917	37,011	43,492	56,648	66,225	76,920	25,487	0.31
<i>J circ as pct of total</i>	32.54%	59.50	53	5.83%	23.08%	24.38%	27.70%	28.79%	32.73%	35.70%	36.04%	40.93%	48.13%	50.27%	54.36%	70.13%	32.03%	0.04
<i>Circulation per capita</i>	7.77	83.00	53	0.58	2.42	2.85	4.12	4.66	5.93	6.53	7.20	7.39	8.70	9.81	11.39	16.63	5.28	0.71
<i>Circulation per visit</i>	1.27	31.10	53	0.47	1.17	1.25	1.33	1.42	1.66	2.01	2.18	2.27	2.35	2.43	2.72	5.24	1.69	-0.51
<i>Circ per item held</i>	1.94	68.00	53	0.27	1.07	1.09	1.19	1.45	1.78	2.04	2.22	2.61	2.81	3.12	3.65	5.40	1.79	0.14
<i>Circ per FTE staff</i>	9,733	34.40	53	1,405	8,159	8,951	11,412	12,481	13,486	15,375	16,862	19,098	20,483	23,446	25,212	34,368	13,311	-0.51
<i>Expenditure per circ</i>	\$4.02	57.40	53	\$0.73	\$2.40	\$2.69	\$3.27	\$3.73	\$4.08	\$5.10	\$5.45	\$6.05	\$6.56	\$7.65	\$10.57	\$14.33	\$4.41	-0.13
Interlibrary loans																		
Loans to	1,004	86.90	53	0	0	3	51	107	187	317	444	597	679	1,893	10,928	46,943	2,029	-0.14
Loans from	302	57.00	53	21	95	134	169	216	372	632	806	1,338	1,562	2,305	13,499	60,439	2,587	-0.25
<i>Net lending</i>	702	96.70	53	-13,496	-448	-306	-135	-75	-52	-31	-19	69	153	301	379	2,878	-557	0.61
Library visits																		
Library visits	76,317	85.20	53	7,269	24,390	30,190	40,963	44,928	51,874	60,981	65,667	71,263	75,912	83,972	96,348	170,493	50,163	0.78
<i>Library visits per capita</i>	6.14	91.20	53	0.55	1.72	1.96	2.65	3.12	3.29	4.27	4.51	4.75	5.00	5.59	7.12	12.48	3.41	1.11
Reference transactions																		
Reference transactions	11,055	68.40	53	255	2,340	2,986	3,516	6,656	8,198	11,546	12,600	15,628	18,104	21,231	30,255	61,304	9,939	0.10
<i>Ref transac per capita</i>	0.89	75.50	53	0.02	0.18	0.18	0.23	0.44	0.56	0.71	0.88	1.07	1.22	1.48	2.00	3.86	0.66	0.32
Staffing																		
MLS librarians	0.00	0.00	53	0.00	0.00	0.00	0.00	0.00	0.94	1.00	1.00	1.00	1.20	2.00	2.25	11.00	0.78	-0.48
Other librarians	6.60	99.60	53	0.00	0.80	0.93	1.00	1.00	1.00	2.06	3.00	3.36	4.00	4.00	4.85	6.75	1.72	2.91
Other paid staff	3.33	50.10	53	0.00	1.80	2.08	2.45	3.32	4.00	5.00	6.22	6.60	8.01	8.27	9.54	14.18	4.06	-0.23
Total FTEs	9.93	86.10	53	1.38	4.00	4.39	4.85	5.50	6.00	7.88	8.52	9.03	9.45	11.12	14.32	25.18	6.56	0.77
<i>Staff FTE / 1,000 pop</i>	0.80	91.90	53	0.08	0.26	0.28	0.32	0.37	0.42	0.55	0.59	0.61	0.68	0.70	0.96	1.84	0.45	1.13
<i>MLS pct of total staff</i>	0.00%	0.00	53	0.00%	0.00%	0.00%	0.00%	0.00%	7.98%	17.41%	21.19%	21.94%	24.75%	27.94%	37.77%	43.69%	9.64%	-0.74

U.S. COUNTY LIBRARIES / 13,000 to 17,000 pop

	Converse Cty Libr	%ile rank	n=	Low	25th %ile	30th %ile	40th %ile	50th %ile	60th %ile	70th %ile	75th %ile	80th %ile	85th %ile	90th %ile	95th %ile	High	Average	z=
Revenue / Income (000s)																		
Local government	\$418	77.60	53	\$0	\$65	\$85	\$105	\$160	\$207	\$312	\$359	\$432	\$450	\$559	\$633	\$856	\$232	0.87
State government	\$0	0.00	53	\$0	\$0	\$3	\$6	\$13	\$22	\$33	\$36	\$45	\$68	\$84	\$315	\$562	\$54	-0.42
Federal government	\$5	85.10	53	\$0	\$0	\$0	\$0	\$0	\$0	\$0	\$1	\$3	\$5	\$10	\$28	\$102	\$5	0.02
Other income	\$12	56.40	53	\$0	\$3	\$4	\$8	\$10	\$13	\$18	\$25	\$31	\$34	\$42	\$66	\$220	\$21	-0.25
Total income	\$435	68.40	53	\$36	\$127	\$142	\$180	\$209	\$292	\$451	\$492	\$538	\$588	\$622	\$720	\$1,017	\$311	0.52
Revenue Analysis																		
Local as pct of total	95.99%	89.50	53	0.00%	72.95%	75.90%	83.00%	85.50%	89.28%	91.32%	92.66%	94.11%	94.79%	96.21%	98.80%	100.00%	74.54%	0.76
State as pct of total	0.00%	0.00	53	0.00%	0.00%	1.29%	2.35%	3.94%	5.91%	11.47%	18.32%	24.07%	46.93%	56.30%	83.33%	95.76%	16.32%	-0.62
Federal as pct of total	1.26%	79.00	53	0.00%	0.00%	0.00%	0.00%	0.00%	0.00%	0.10%	0.73%	1.66%	3.24%	7.98%	11.16%	15.03%	1.73%	-0.12
Other as pct of total	2.75%	30.70	53	0.00%	2.19%	2.55%	3.29%	4.91%	6.13%	7.69%	9.14%	11.02%	12.62%	14.85%	20.67%	62.71%	7.42%	-0.46
Revenue per capita	\$35.01	78.10	53	\$2.17	\$8.52	\$8.95	\$11.91	\$13.37	\$20.50	\$28.57	\$32.18	\$37.27	\$39.18	\$41.68	\$49.18	\$74.45	\$21.11	0.83
Expenditures (000s)																		
Salaries	\$195	66.70	48	\$33	\$76	\$83	\$101	\$119	\$146	\$205	\$211	\$235	\$299	\$321	\$395	\$1,255	\$176	0.10
Benefits	\$52	68.50	48	\$0	\$17	\$21	\$28	\$42	\$49	\$57	\$65	\$82	\$97	\$110	\$128	\$455	\$55	-0.03
Total staff expense	\$247	65.10	48	\$36	\$100	\$107	\$123	\$163	\$211	\$268	\$283	\$297	\$385	\$421	\$509	\$1,709	\$231	0.06
Materials	\$59	82.00	53	\$2	\$14	\$17	\$19	\$26	\$37	\$47	\$52	\$54	\$63	\$82	\$119	\$212	\$39	0.50
Other expense	\$82	67.60	48	\$1	\$27	\$29	\$36	\$53	\$74	\$89	\$107	\$119	\$130	\$155	\$175	\$1,158	\$91	-0.05
Total operating expense	\$388	66.90	53	\$30	\$114	\$143	\$177	\$206	\$287	\$417	\$445	\$501	\$538	\$590	\$689	\$3,079	\$336	0.12
Capital expense	\$0	0.00	53	\$0	\$0	\$0	\$0	\$0	\$1	\$4	\$7	\$13	\$19	\$34	\$45	\$430	\$16	-0.27
Expenditure analysis																		
Benefits as pct of staff	21.24%	44.30	48	0.00%	17.51%	18.26%	20.25%	22.53%	24.06%	26.52%	27.94%	30.33%	31.91%	33.51%	37.88%	47.24%	21.97%	-0.07
Sal & ben as pct of op	63.66%	38.70	48	42.24%	57.94%	61.27%	64.15%	66.51%	67.96%	70.91%	71.68%	74.77%	76.21%	77.00%	78.36%	90.64%	65.37%	-0.16
Matl exp as pct of op	15.19%	77.40	53	4.50%	9.22%	9.77%	10.87%	12.06%	13.02%	14.09%	14.59%	16.13%	16.78%	18.27%	21.44%	23.98%	12.47%	0.58
Expenditure per capita	\$31.22	76.60	53	\$1.79	\$8.26	\$9.21	\$11.68	\$13.80	\$19.80	\$28.13	\$30.38	\$34.46	\$35.75	\$40.52	\$45.35	\$225.31	\$22.96	0.26
Mats exp per capita	\$4.74	88.40	53	\$0.14	\$0.98	\$1.10	\$1.33	\$1.69	\$2.55	\$3.16	\$3.49	\$3.68	\$4.02	\$5.42	\$8.31	\$15.50	\$2.67	0.75

ALL HIGH PLAINS REGIONAL

	Converse Cty Libr	%ile rank	n=	Low	25th %ile	30th %ile	40th %ile	50th %ile	60th %ile	70th %ile	75th %ile	80th %ile	85th %ile	90th %ile	95th %ile	High	Average	z=	
Population	12,433	82.00	793	32	797	982	1,444	2,140	3,532	6,167	8,039	11,127	15,304	25,295	49,087	702,987	14,333	-0.04	
Configuration																			
Central	1	4.00	793	0	1	1	1	1	1	1	1	1	1	1	1	1	1	1	0.20
Branch	1	86.20	793	0	0	0	0	0	0	0	0	0	0	1	3	22	0	0.34	
Bookmobile	0	0.00	793	0	0	0	0	0	0	0	0	0	0	0	1	2	0	-0.27	
Hours open	4,628	91.70	793	101	1,040	1,195	1,508	1,820	2,150	2,550	2,756	2,990	3,266	3,950	6,811	52,546	2,604	0.50	
Holdings																			
Volumes held	49,884	82.80	793	30	8,885	10,120	12,735	15,907	20,591	29,037	34,856	43,699	54,293	85,977	139,791	#####	45,313	0.03	
Periodical subscriptions	139	84.70	793	0	12	18	26	36	48	68	79	98	141	208	294	6,481	103	0.10	
Audio recordings held	2,403	86.60	793	0	102	133	215	342	545	910	1,083	1,493	2,065	3,404	7,845	186,775	2,189	0.02	
Video recordings held	2,364	86.70	793	0	199	245	357	473	649	977	1,225	1,544	2,048	2,905	5,673	308,010	2,126	0.02	
Holdings analysis																			
<i>Volumes held per capita</i>	4.01	27.20	793	0.04	3.83	4.34	5.68	7.35	9.11	11.24	13.06	14.73	14.89	17.66	25.13	97.33	9.73	-0.61	
<i>Subscrips per 1,000 pop</i>	11.18	47.60	793	0.00	5.70	6.96	9.10	12.20	16.76	24.97	29.10	34.89	37.04	40.79	56.70	255.32	20.62	-0.36	
<i>Audios per 1,000 pop</i>	193.28	66.40	793	0.00	75.26	90.27	116.71	150.04	187.09	215.15	237.92	264.71	327.06	400.50	533.24	3,731.34	200.85	-0.03	
<i>Videos per 1,000 pop</i>	190.14	49.60	793	0.00	87.57	109.37	147.99	190.48	256.11	375.13	437.57	510.84	512.99	596.82	940.39	#####	317.01	-0.25	
<i>Nonprint as pct of print</i>	9.56%	81.40	793	0.00%	3.48%	3.86%	4.74%	5.42%	6.51%	7.69%	8.34%	9.16%	10.44%	11.94%	14.58%	#####	8.56%	0.02	
Automation access																			
Internet PCs for public	18	90.10	793	0	2	2	3	4	5	7	8	10	13	17	26	466	10	0.32	
<i>Public PCs per 1,000 pop</i>	1.45	51.00	793	0.00	0.65	0.80	1.07	1.42	1.85	2.52	3.00	3.68	4.33	5.80	8.50	62.50	2.50	-0.28	
<i>Public PCs per 1,000 visits</i>	0.24	42.50	793	0.00	0.12	0.15	0.22	0.29	0.39	0.51	0.62	0.76	0.95	1.27	1.93	22.73	0.59	-0.28	
<i>Public PCs per 1,000 vol</i>	0.36	75.80	793	0.00	0.13	0.15	0.19	0.22	0.27	0.33	0.35	0.38	0.45	0.53	0.80	33.33	0.33	0.03	
Internet PCs for staff																			
<i>Staff PCs per FTE</i>																			

ALL HIGH PLAINS REGIONAL

	Converse Cty Libr	%ile rank	n=	Low	25th %ile	30th %ile	40th %ile	50th %ile	60th %ile	70th %ile	75th %ile	80th %ile	85th %ile	90th %ile	95th %ile	High	Average	z=
Circulation																		
Circulation	96,645	82.10	793	19	5,036	6,785	11,240	16,704	25,969	46,723	62,241	80,889	134,912	221,581	422,363	#####	137,162	-0.06
J circulation	31,449	81.10	793	5	1,800	2,426	4,264	6,241	10,237	17,929	23,175	30,236	51,938	89,225	160,555	#####	52,218	-0.09
<i>J circ as pct of total</i>	32.54%	36.30	793	0.14%	28.67%	30.06%	33.82%	37.88%	41.94%	46.62%	49.27%	52.00%	55.73%	59.98%	66.77%	92.23%	39.88%	-0.49
<i>Circulation per capita</i>	7.77	51.10	793	0.10	4.79	5.49	6.48	7.62	9.19	9.85	10.93	12.14	13.61	16.00	19.30	61.61	8.77	-0.17
<i>Circulation per visit</i>	1.27	36.20	793	0.02	1.08	1.16	1.34	1.54	1.75	1.99	2.08	2.24	2.50	3.00	3.96	21.04	1.87	-0.35
<i>Circ per item held</i>	1.94	74.20	793	0.00	0.59	0.63	0.84	1.13	1.36	1.71	1.97	2.22	2.57	3.16	4.27	232.60	1.79	0.02
<i>Circ per FTE staff</i>	9,733	38.60	788	538	7,834	8,809	9,802	11,273	13,066	15,285	16,813	18,624	20,854	24,388	31,150	88,566	13,533	-0.40
<i>Expenditure per circ</i>	\$4.02	69.80	793	\$0.42	\$2.32	\$2.51	\$2.81	\$3.08	\$3.50	\$4.03	\$4.53	\$5.10	\$5.78	\$6.81	\$8.78	\$93.76	\$4.21	-0.03
Interlibrary loans																		
Loans to	1,004	89.70	793	0	0	0	3	19	42	84	149	256	512	1,036	2,179	29,109	461	0.28
Loans from	302	69.90	793	0	35	46	79	125	185	302	384	500	746	1,198	2,224	27,397	514	-0.13
<i>Net lending</i>	702	95.30	793	-3,485	-166	-121	-65	-36	-20	-9	-4	0	34	158	573	8,143	-52	0.94
Library visits																		
Library visits	76,317	82.80	793	44	3,105	4,036	7,193	11,180	17,736	32,061	41,600	57,711	91,362	163,873	265,000	#####	83,215	-0.02
<i>Library visits per capita</i>	6.14	64.10	793	0.07	3.11	3.46	4.30	4.83	5.82	6.85	7.45	8.28	9.39	10.68	13.58	48.51	5.97	0.04
Reference transactions																		
Reference transactions	11,055	85.40	793	0	288	415	707	1,248	2,105	3,670	4,680	6,730	10,411	22,196	49,624	#####	16,405	-0.06
<i>Ref transac per capita</i>	0.89	71.20	793	0.00	0.24	0.29	0.42	0.61	0.78	0.88	0.97	1.20	1.41	1.79	2.61	23.04	0.89	0.00
Staffing																		
MLS librarians	0.00	0.00	793	0.00	0.00	0.00	0.00	0.00	0.00	0.00	0.00	0.50	1.00	2.00	5.00	110.50	1.22	-0.19
Other librarians	6.60	97.20	793	0.00	0.38	0.48	0.60	0.88	1.00	1.02	1.50	1.88	2.70	3.20	5.00	22.63	1.40	2.58
Other paid staff	3.33	81.30	793	0.00	0.00	0.03	0.14	0.38	0.68	1.40	2.00	2.88	4.57	9.02	17.91	313.75	4.91	-0.08
Total FTEs	9.93	86.60	793	0.00	0.59	0.72	1.00	1.53	2.20	3.39	4.50	5.90	8.36	14.56	25.65	429.75	7.54	0.09
<i>Staff FTE / 1,000 pop</i>	0.80	63.60	793	0.00	0.44	0.48	0.56	0.65	0.76	0.89	0.96	1.02	1.15	1.33	1.86	10.14	0.80	-0.01
<i>MLS pct of total staff</i>	0.00%	0.00	788	0.00%	0.00%	0.00%	0.00%	0.00%	0.00%	0.00%	0.00%	7.71%	14.26%	20.68%	28.00%	100.00%	5.28%	-0.39

ALL HIGH PLAINS REGIONAL

	Converse Cty Libr	%ile rank	n=	Low	25th %ile	30th %ile	40th %ile	50th %ile	60th %ile	70th %ile	75th %ile	80th %ile	85th %ile	90th %ile	95th %ile	High	Average	z=
Revenue / Income (000s)																		
Local government	\$418	85.60	793	\$0	\$15	\$19	\$29	\$45	\$73	\$130	\$178	\$246	\$383	\$692	\$1,391	\$30,147	\$434	-0.01
State government	\$0	0.00	793	\$0	\$0	\$0	\$0	\$0	\$1	\$1	\$2	\$4	\$5	\$8	\$16	\$99	\$3	-0.35
Federal government	\$5	94.60	793	\$0	\$0	\$0	\$0	\$0	\$0	\$0	\$0	\$0	\$1	\$2	\$6	\$240	\$1	0.41
Other income	\$12	74.60	793	\$0	\$1	\$1	\$2	\$3	\$6	\$10	\$12	\$17	\$25	\$45	\$92	\$2,843	\$31	-0.12
Total income	\$435	85.20	793	\$0	\$19	\$24	\$36	\$56	\$86	\$147	\$200	\$282	\$426	\$729	\$1,530	\$32,908	\$470	-0.02
Revenue Analysis																		
Local as pct of total	95.99%	72.10	792	0.00%	76.84%	79.18%	86.15%	90.39%	93.46%	95.67%	96.46%	97.31%	98.51%	99.60%	100.00%	100.00%	83.98%	0.66
State as pct of total	0.00%	0.00	792	0.00%	0.00%	0.00%	0.00%	0.49%	1.42%	2.83%	3.14%	3.80%	4.86%	7.69%	13.70%	84.92%	3.00%	-0.44
Federal as pct of total	1.26%	90.20	792	0.00%	0.00%	0.00%	0.00%	0.00%	0.00%	0.00%	0.00%	0.00%	0.19%	1.17%	5.71%	99.37%	0.86%	0.09
Other as pct of total	2.75%	33.80	792	0.00%	1.25%	1.96%	3.93%	6.01%	8.74%	13.51%	16.82%	21.70%	22.43%	30.72%	44.25%	100.00%	12.16%	-0.56
Revenue per capita	\$35.01	71.20	793	\$0.00	\$16.97	\$18.55	\$20.37	\$24.28	\$29.10	\$34.33	\$36.95	\$39.64	\$42.78	\$49.43	\$64.58	\$409.22	\$29.93	0.20
Expenditures (000s)																		
Salaries	\$195	63.30	328	\$4	\$63	\$71	\$88	\$124	\$168	\$265	\$349	\$472	\$596	\$1,018	\$2,104	\$17,560	\$530	-0.22
Benefits	\$52	64.80	328	\$0	\$13	\$15	\$22	\$33	\$46	\$70	\$96	\$131	\$175	\$262	\$595	\$4,929	\$144	-0.21
Total staff expense	\$247	63.60	328	\$4	\$76	\$89	\$117	\$157	\$218	\$335	\$448	\$612	\$743	\$1,285	\$2,700	\$22,490	\$674	-0.22
Materials	\$59	84.80	793	\$0	\$3	\$4	\$7	\$9	\$13	\$21	\$28	\$39	\$59	\$91	\$189	\$5,721	\$68	-0.03
Other expense	\$82	63.90	328	\$0	\$25	\$29	\$36	\$49	\$72	\$99	\$112	\$166	\$213	\$341	\$725	\$5,280	\$191	-0.21
Total operating expense	\$388	84.70	793	\$0	\$18	\$23	\$34	\$51	\$83	\$129	\$176	\$258	\$392	\$694	\$1,405	\$31,927	\$439	-0.03
Capital expense	\$0	0.00	793	\$0	\$0	\$0	\$0	\$1	\$2	\$4	\$5	\$10	\$17	\$28	\$130	\$8,480	\$72	-0.14
Expenditure analysis																		
Benefits as pct of staff	21.24%	57.40	328	0.00%	14.56%	16.01%	18.49%	20.11%	21.47%	23.02%	23.94%	25.25%	26.68%	27.91%	29.86%	39.53%	19.23%	0.27
Sal & ben as pct of op	63.66%	43.10	328	21.86%	59.24%	60.56%	62.87%	64.78%	66.88%	69.02%	70.46%	71.78%	73.15%	74.80%	78.96%	86.27%	64.32%	-0.07
Matl exp as pct of op	15.19%	42.10	793	0.00%	12.06%	13.08%	14.71%	16.81%	18.83%	22.50%	22.88%	24.28%	26.92%	31.80%	42.11%	100.00%	19.18%	-0.34
Expenditure per capita	\$31.22	69.80	793	\$0.87	\$16.14	\$17.52	\$21.26	\$25.41	\$26.96	\$31.51	\$33.63	\$36.16	\$39.15	\$43.77	\$57.67	\$459.22	\$27.99	0.13
Mails exp per capita	\$4.74	59.80	793	\$0.00	\$2.36	\$2.76	\$3.33	\$3.95	\$4.74	\$5.97	\$6.01	\$6.67	\$7.60	\$9.78	\$13.27	\$67.38	\$5.13	-0.07

HIGH PLAINS REGIONAL LIBRARIES / 10,000 to 25,000 pop

	Converse Cty Libr	%ile rank	n=	Low	25th %ile	30th %ile	40th %ile	50th %ile	60th %ile	70th %ile	75th %ile	80th %ile	85th %ile	90th %ile	95th %ile	High	Average	z=	
Population	12,433	29.50	89	10,011	11,893	12,464	13,444	14,844	15,659	17,569	18,837	20,027	21,416	22,031	23,574	24,253	15,618	-0.75	
Configuration																			
Central	1	9.00	89	0	1	1	1	1	1	1	1	1	1	1	1	1	1	1	0.31
Branch	1	70.40	89	0	0	0	0	0	0	1	1	1	2	2	4	8	1	0.12	
Bookmobile	0	0.00	89	0	0	0	0	0	0	0	0	0	0	1	1	2	0	-0.40	
Hours open	4,628	82.90	89	1,612	2,760	2,808	2,914	3,020	3,287	3,433	3,588	4,008	4,890	5,796	8,182	16,000	3,714	0.44	
Holdings																			
Volumes held	49,884	54.50	89	17,881	34,203	37,279	41,438	47,923	52,549	57,474	64,530	71,756	82,833	91,750	97,960	175,047	53,381	-0.13	
Periodical subscriptions	139	67.00	89	0	68	74	80	98	122	145	162	171	212	223	266	320	119	0.27	
Audio recordings held	2,403	75.00	89	10	963	1,062	1,276	1,560	1,806	2,255	2,403	2,885	3,448	4,258	6,603	24,118	2,287	0.04	
Video recordings held	2,364	69.30	89	0	743	1,000	1,312	1,739	2,007	2,375	2,600	2,865	3,156	3,448	4,489	6,520	1,862	0.39	
Holdings analysis																			
<i>Volumes held per capita</i>	4.01	75.00	89	1.41	2.37	2.52	2.82	3.08	3.36	3.84	4.01	4.22	4.62	6.03	7.52	16.47	3.59	0.20	
<i>Subscrips per 1,000 pop</i>	11.18	82.90	89	0.00	5.01	5.26	5.70	7.08	7.82	9.78	10.57	10.95	12.27	14.89	17.33	24.08	7.91	0.65	
<i>Audios per 1,000 pop</i>	193.28	80.60	89	0.50	66.12	70.15	84.30	103.86	116.59	143.18	157.35	191.73	224.06	256.20	328.49	2,010.84	151.35	0.18	
<i>Videos per 1,000 pop</i>	190.14	80.60	89	0.00	58.79	66.99	84.74	98.90	134.25	166.19	175.05	185.48	193.84	226.69	263.58	352.28	120.80	0.84	
<i>Nonprint as pct of print</i>	9.56%	72.70	89	0.05%	4.23%	5.10%	5.72%	6.59%	7.70%	8.70%	10.05%	10.79%	12.05%	13.64%	16.87%	30.38%	7.71%	0.36	
Automation access																			
Internet PCs for public	18	82.90	89	0	6	7	8	9	13	14	15	16	18	21	25	40	11	0.90	
<i>Public PCs per 1,000 pop</i>	1.45	90.90	89	0.00	0.41	0.45	0.53	0.64	0.78	0.92	0.98	1.08	1.28	1.37	1.74	2.92	0.76	1.39	
<i>Public PCs per 1,000 visits</i>	0.24	78.40	89	0.00	0.09	0.09	0.11	0.13	0.16	0.21	0.23	0.26	0.28	0.31	0.35	8.65	0.28	-0.04	
<i>Public PCs per 1,000 vol</i>	0.36	85.20	89	0.00	0.13	0.15	0.17	0.20	0.23	0.26	0.28	0.32	0.36	0.43	0.47	0.84	0.23	1.00	
Internet PCs for staff																			
<i>Staff PCs per FTE</i>																			

HIGH PLAINS REGIONAL LIBRARIES / 10,000 to 25,000 pop

	Converse Cty Libr	%ile rank	n=	Low	25th %ile	30th %ile	40th %ile	50th %ile	60th %ile	70th %ile	75th %ile	80th %ile	85th %ile	90th %ile	95th %ile	High	Average	z=
Circulation																		
Circulation	96,645	40.90	89	2,741	72,452	79,233	96,593	103,103	144,231	162,605	175,211	183,092	232,570	251,856	325,106	377,554	134,375	-0.43
J circulation	31,449	42.00	89	361	23,500	25,425	30,314	43,140	54,835	69,426	74,304	83,814	104,663	117,285	141,640	218,522	56,085	-0.56
<i>J circ as pct of total</i>	32.54%	34.00	89	13.17%	30.00%	31.81%	34.56%	39.47%	45.13%	47.59%	49.03%	50.36%	53.71%	56.68%	59.62%	79.27%	40.34%	-0.61
<i>Circulation per capita</i>	7.77	52.20	89	0.18	4.76	5.28	6.97	7.62	8.83	10.12	10.76	11.81	12.76	14.13	17.58	21.17	8.36	-0.13
<i>Circulation per visit</i>	1.27	32.90	89	0.22	1.18	1.24	1.32	1.45	1.58	1.79	1.98	2.20	2.40	2.88	3.63	21.04	1.90	-0.28
<i>Circ per item held</i>	1.94	39.70	89	0.06	1.60	1.68	1.94	2.19	2.72	3.30	3.40	3.69	4.34	4.66	5.49	6.79	2.63	-0.47
<i>Circ per FTE staff</i>	9,733	20.40	89	548	10,493	11,340	12,848	14,782	17,801	19,844	21,901	24,087	26,021	31,409	35,710	66,093	17,778	-0.72
<i>Expenditure per circ</i>	\$4.02	70.40	89	\$0.53	\$2.19	\$2.30	\$2.81	\$3.07	\$3.63	\$4.00	\$4.49	\$4.95	\$5.42	\$5.90	\$7.40	\$93.76	\$4.65	-0.06
Interlibrary loans																		
Loans to	1,004	78.40	89	0	5	17	108	235	434	594	784	1,025	1,481	1,811	2,628	3,967	608	0.46
Loans from	302	34.00	89	20	180	246	331	441	614	1,029	1,294	1,564	1,863	2,318	2,839	4,213	869	-0.60
<i>Net lending</i>	702	90.90	89	-3,485	-537	-355	-253	-112	-65	28	59	279	352	606	1,021	2,246	-261	1.08
Library visits																		
Library visits	76,317	51.10	89	1,040	49,846	51,907	58,144	75,400	89,506	102,354	112,054	123,822	142,346	155,820	187,729	304,262	87,776	-0.19
<i>Library visits per capita</i>	6.14	67.00	89	0.07	3.26	3.65	4.39	4.88	5.79	6.46	6.96	7.36	7.75	8.38	11.07	25.07	5.62	0.13
Reference transactions																		
Reference transactions	11,055	65.90	89	340	3,800	4,680	6,130	7,244	9,367	11,790	15,770	21,903	24,611	29,967	37,777	74,500	12,495	-0.11
<i>Ref transac per capita</i>	0.89	72.70	89	0.03	0.28	0.31	0.40	0.57	0.68	0.81	0.93	1.10	1.45	1.75	2.24	3.45	0.75	0.20
Staffing																		
MLS librarians	0.00	0.00	89	0.00	0.00	0.00	0.00	0.00	1.00	1.00	1.00	2.00	2.00	2.12	3.00	6.60	0.90	-0.70
Other librarians	6.60	93.10	89	0.00	1.00	1.00	1.66	2.14	3.00	3.48	4.00	4.20	4.98	5.34	6.75	10.00	2.72	1.83
Other paid staff	3.33	44.30	89	0.00	1.90	2.17	2.87	3.50	4.00	5.96	7.00	7.50	8.20	9.30	12.28	32.50	4.71	-0.30
Total FTEs	9.93	72.70	89	0.80	5.00	5.50	6.04	7.25	8.22	9.15	10.25	10.81	11.98	15.15	16.78	38.25	8.33	0.31
<i>Staff FTE / 1,000 pop</i>	0.80	89.70	89	0.07	0.36	0.39	0.43	0.49	0.53	0.58	0.65	0.67	0.72	0.82	1.08	2.06	0.54	0.81
<i>MLS pct of total staff</i>	0.00%	0.00	89	0.00%	0.00%	0.00%	0.00%	0.00%	11.72%	13.61%	16.92%	17.94%	20.49%	23.60%	32.21%	44.66%	9.24%	-0.81

HIGH PLAINS REGIONAL LIBRARIES / 10,000 to 25,000 pop

	Converse Cty Libr	%ile rank	n=	Low	25th %ile	30th %ile	40th %ile	50th %ile	60th %ile	70th %ile	75th %ile	80th %ile	85th %ile	90th %ile	95th %ile	High	Average	z=
Revenue / Income (000s)																		
Local government	\$418	62.50	89	\$33	\$212	\$224	\$255	\$307	\$383	\$472	\$517	\$603	\$642	\$712	\$942	\$2,291	\$416	0.00
State government	\$0	0.00	89	\$0	\$0	\$0	\$0	\$3	\$5	\$6	\$7	\$9	\$10	\$13	\$21	\$50	\$5	-0.64
Federal government	\$5	94.30	89	\$0	\$0	\$0	\$0	\$0	\$0	\$0	\$0	\$1	\$2	\$5	\$7	\$26	\$1	1.02
Other income	\$12	51.10	89	\$0	\$3	\$5	\$7	\$12	\$15	\$26	\$32	\$38	\$45	\$68	\$90	\$454	\$28	-0.29
Total income	\$435	62.50	89	\$64	\$236	\$253	\$293	\$362	\$424	\$502	\$557	\$629	\$678	\$737	\$982	\$2,357	\$451	-0.05
Revenue Analysis																		
Local as pct of total	95.99%	65.90	89	37.18%	89.44%	90.75%	93.12%	94.79%	95.66%	96.72%	97.61%	98.09%	98.50%	98.74%	99.16%	100.00%	90.86%	0.44
State as pct of total	0.00%	0.00	89	0.00%	0.00%	0.00%	0.00%	0.61%	1.57%	2.13%	2.39%	2.82%	3.61%	6.73%	9.72%	23.61%	2.29%	-0.53
Federal as pct of total	1.26%	92.00	89	0.00%	0.00%	0.00%	0.00%	0.00%	0.00%	0.00%	0.00%	0.23%	0.55%	1.10%	2.49%	21.94%	0.59%	0.27
Other as pct of total	2.75%	46.50	89	0.00%	1.09%	1.29%	1.89%	3.43%	5.01%	5.74%	6.89%	7.94%	9.86%	13.32%	23.51%	62.82%	6.27%	-0.35
Revenue per capita	\$35.01	71.50	89	\$5.68	\$16.92	\$17.40	\$19.42	\$21.90	\$27.41	\$34.25	\$35.92	\$37.19	\$40.79	\$43.80	\$65.07	\$161.39	\$29.43	0.23
Expenditures (000s)																		
Salaries	\$195	55.10	88	\$29	\$116	\$124	\$148	\$176	\$220	\$238	\$257	\$289	\$334	\$386	\$503	\$1,234	\$219	-0.14
Benefits	\$52	65.50	88	\$4	\$29	\$32	\$39	\$45	\$49	\$56	\$67	\$75	\$84	\$101	\$130	\$509	\$57	-0.07
Total staff expense	\$247	55.10	88	\$33	\$144	\$158	\$183	\$221	\$265	\$299	\$320	\$365	\$418	\$452	\$633	\$1,743	\$276	-0.13
Materials	\$59	60.20	89	\$5	\$31	\$33	\$40	\$46	\$59	\$69	\$74	\$80	\$90	\$111	\$143	\$260	\$59	0.00
Other expense	\$82	60.90	88	\$10	\$43	\$47	\$60	\$70	\$81	\$89	\$101	\$105	\$115	\$149	\$248	\$478	\$86	-0.05
Total operating expense	\$388	55.60	89	\$64	\$226	\$235	\$287	\$310	\$400	\$464	\$490	\$546	\$606	\$709	\$919	\$2,166	\$418	-0.09
Capital expense	\$0	0.00	89	\$0	\$0	\$0	\$1	\$4	\$10	\$15	\$22	\$26	\$34	\$52	\$232	\$2,782	\$62	-0.20
Expenditure analysis																		
Benefits as pct of staff	21.24%	55.10	88	5.11%	14.61%	16.37%	19.33%	20.89%	21.49%	22.40%	23.36%	24.15%	26.51%	28.10%	30.72%	38.89%	19.96%	0.19
Sal & ben as pct of op	63.66%	39.00	88	43.72%	59.93%	61.57%	63.76%	65.16%	66.48%	68.33%	70.23%	71.71%	73.37%	74.65%	76.50%	80.46%	64.82%	-0.15
Matl exp as pct of op	15.19%	55.60	89	4.75%	10.88%	11.72%	13.26%	14.54%	16.26%	17.49%	17.94%	18.67%	19.38%	21.81%	23.25%	31.71%	14.74%	0.09
Expenditure per capita	\$31.22	72.70	89	\$5.68	\$16.14	\$16.94	\$19.23	\$21.90	\$25.41	\$30.51	\$32.78	\$35.74	\$37.19	\$40.99	\$58.02	\$153.66	\$27.17	0.19
Mats exp per capita	\$4.74	77.20	89	\$0.41	\$2.12	\$2.42	\$2.95	\$3.43	\$3.81	\$4.17	\$4.47	\$4.83	\$5.37	\$6.03	\$7.98	\$21.67	\$3.79	0.33

*APPENDIX D: CONVERTING AN
EXISTING STRUCTURE
TO A NEW USE AS A
LIBRARY*

If at some future time a building is recommended for conversion, the following considerations should be made. (Note that many of these thoughts can also be adapted and directed toward new construction or any other expansion option.)

Size

The most basic consideration in examining any existing building is whether the structure contains enough space to meet the library's long-term space needs, as dictated by the library's anticipated program of service. If the existing building provides less space than the library needs, how much is available and to what degree will the reduction in available space compromise the library's ability to deliver service? Or can the building be expanded in the future to meet the stated long-term needs? If the building provides more space than the library needs, can some of the excess space be reserved in some manner for future expansion? Is there so much additional space in the building that it becomes a burden for the library to carry (and service and maintain)?

Configuration

The shape of the building and the distribution of space within the building should support library use. A simple geometric plan is generally more adaptable to a new use than an irregular one. To what degree have interior spaces been designed to support specific, non-library uses? Are interior spaces clear and

open, or are sight lines interrupted by internal structures (atria or courtyards or partitions)? If the building contains multiple levels, is a multi-level distribution of library collections and services appropriate? Does the distribution of space among multiple levels correspond to a sensible distribution of *library* services and space? Are interior spaces and rooms already defined in a way that corresponds to the identified needs of individual library functional areas?

Floor loading

Library bookstacks impose a significant load on the floors of whatever structure they occupy. A double-faced section of shelving, loaded to capacity, weighs just under one ton. Spread over the amount of floor space occupied by a typical shelving unit, the weight averages 150 pounds per square foot. Most building codes call out a requirement that the floors in library bookstacks be engineered to meet this requirement. In comparison with other building types, it is a most unusual requirement (in Wisconsin, for example, the state building code lists only two uses – heavy warehousing and aerial promenades – that exceed this requirement; among other uses that are significantly less stringent than library bookstacks are school classrooms and parking decks for passenger cars, both at 50 pounds per square foot). Obviously, the strength of any building proposed for conversion should be tested before any action is taken. If the floors don't meet code requirements, it is usually possible to reinforce them, but at a cost.

Ceiling heights

Ideally, there should be 10' clear to allow for the installation of full-height bookstacks (at 7' or 7'6" tall), plus the installation of light fixtures on the ceiling,

Data transmission

The same can be said for data transmission. More and more, libraries rely on cooperative data networks to deliver services. Automated circulation systems and on-line catalogs and Local Area Networks (LANs) require connections among terminals and linked PCs. While it is unlikely that an existing building will be able to support internal and/or external data transmission without substantial modification, how substantial would the modifications need to be?

Bearing walls

Bearing walls and structures should be kept to a minimum. Library space functions to the greatest advantage when it is open, clear, and flexible, when there are the fewest restrictions possible on how space can be rearranged and reassigned. Usually this leads to buildings designed on a structural module employing columns and beams to support the structure. Are there load-bearing walls? Where? What would be involved in removing or re-engineering inconveniently located walls (aside from dollars)? In a related vein, for existing buildings that are designed using columns and beams, where are the columns located? What is the dimension between columns and does that dimension correspond with typical library furnishings patterns (i.e., library shelving installed with a three or a three and a half foot aisle)?

Entrance

The current entrance to the building proposed for conversion may not be situated sensibly for library use. If the entrance is retained in its original location,

Accessibility

Handicapped access is important in any conversion. Does the building already meet code requirements, or is remodeling called for to bring the structure up to code (a change of use will necessitate a building upgrade to meet code)? Are doors wide enough? is the entry at grade? are switches and other fixtures designated by code at a proper height? is there suitable access between floor levels? and so on.

Other hazards

Other conditions will sometimes come into play, particularly in an older structure. Is there friable asbestos in the structure? Are there other hazardous chemicals or substances present in the structure? The remedies for these conditions can affect the cost of retrofitting an existing structure dramatically.

*APPENDIX E: CURRENT FLOOR
PLANS*

Sketches of the current Douglas facility main / entry level and the
Glenrock facility are provided on the following pages.

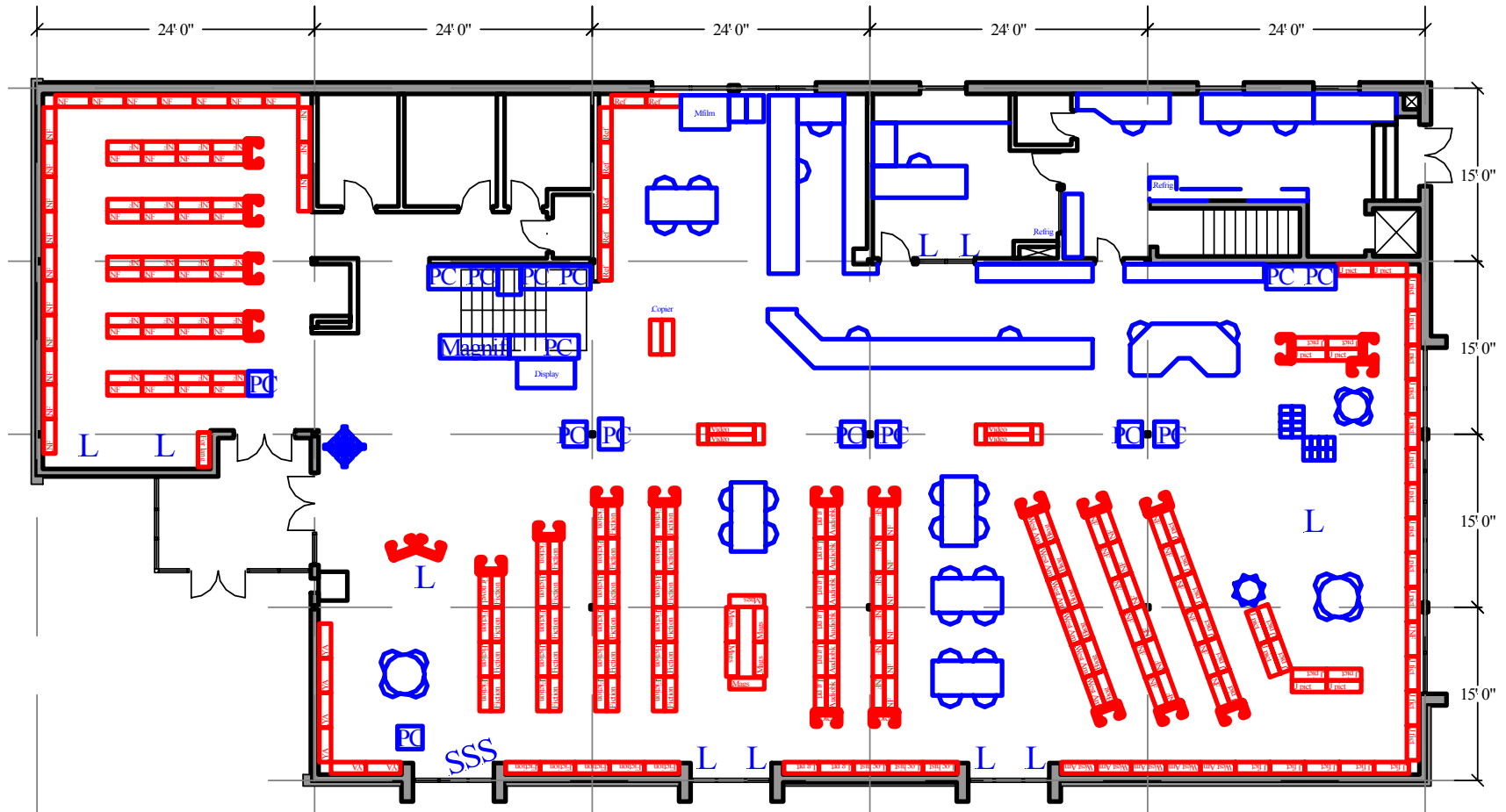

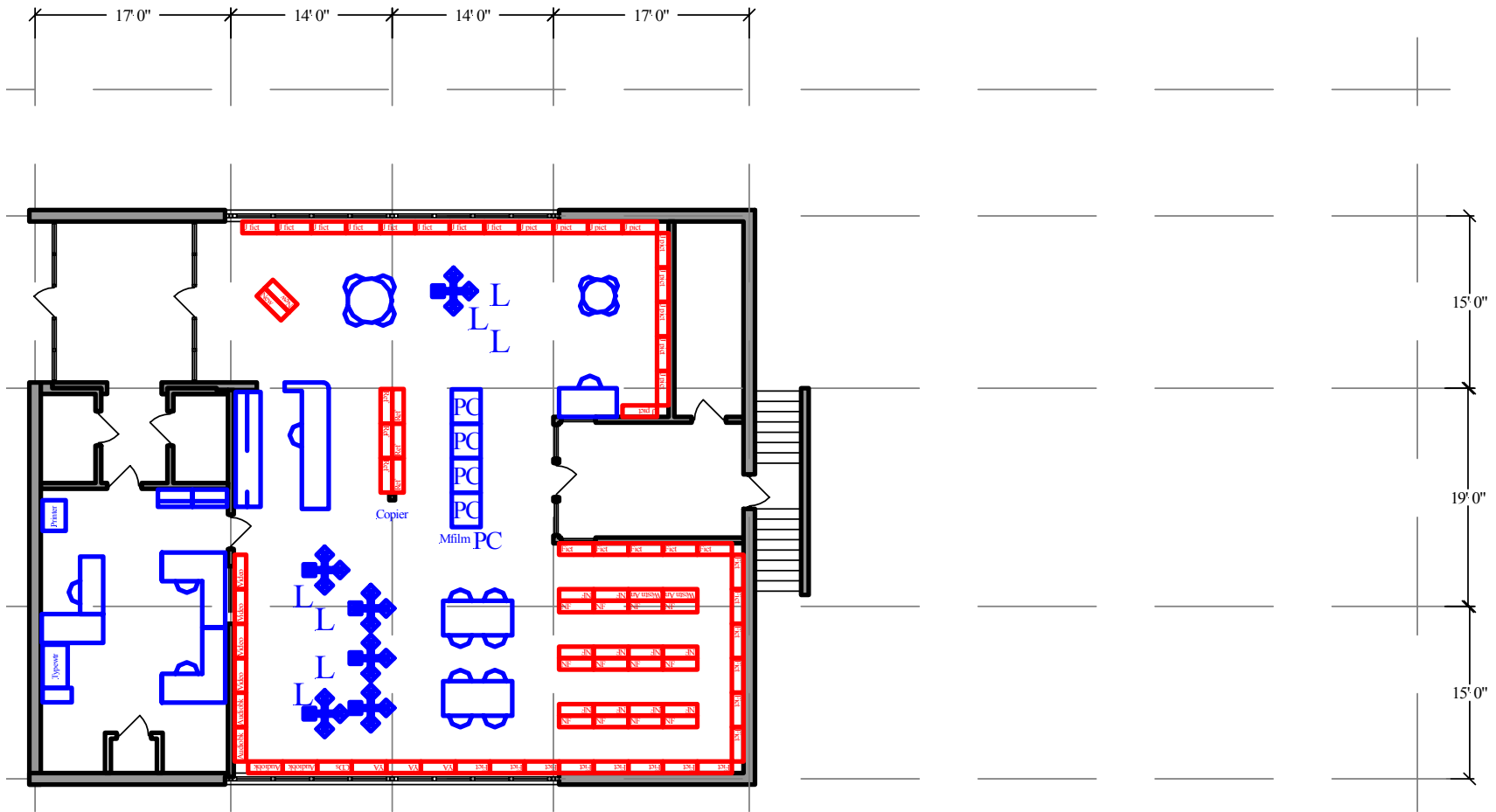

Notes

Notes

Notes